

---

# WASHER NOZZLE

## ADJUSTMENT

### 1. INSPECT WASHER NOZZLE

- (a) With the engine running, check that the point where the washer fluid hits the windshield and the rear window is within the range indicated by the hatched line.

Windshield

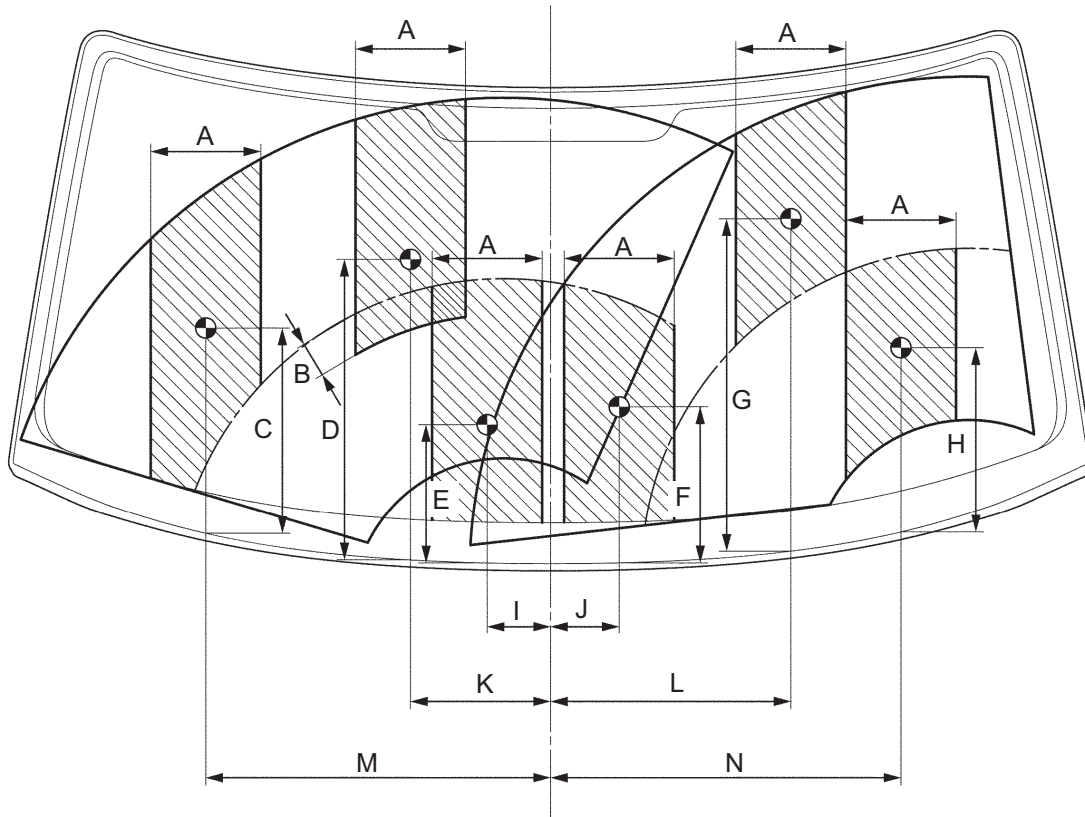

- |                         |                         |
|-------------------------|-------------------------|
| A: 150 mm (5.90 in.)    | I: 89.5 mm (3.52 in.)   |
| B: 50 mm (1.96 in.)     | J: 93 mm (3.66 in.)     |
| C: 285.9 mm (11.25 in.) | K: 194.7 mm (7.66 in.)  |
| D: 416.4 mm (16.39 in.) | L: 329.9 mm (12.98 in.) |
| E: 193 mm (7.59 in.)    | M: 474.8 mm (18.69 in.) |
| F: 217.7 mm (8.57 in.)  | N: 479.5 mm (18.87 in.) |
| G: 458.8 mm (18.06 in.) |                         |
| H: 253.7 mm (9.98 in.)  |                         |

WW

Rear Window

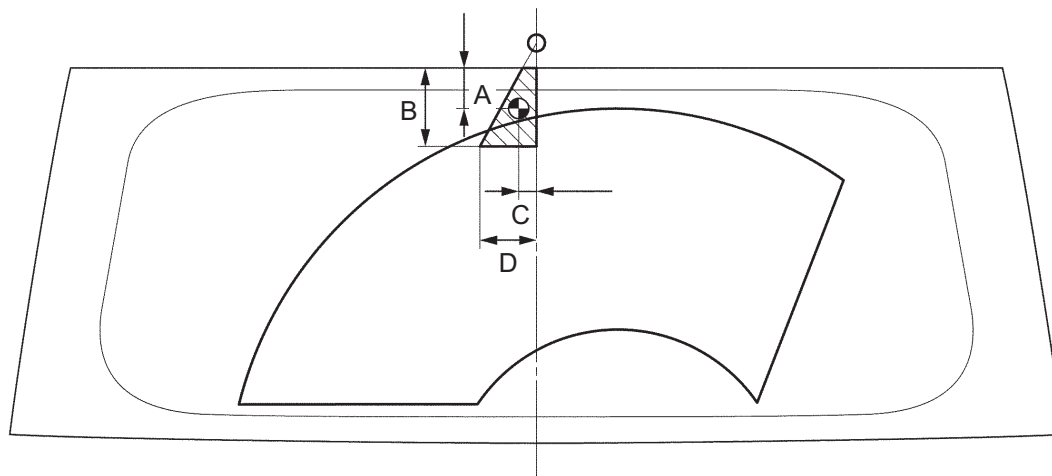

- A: 50 mm (1.96 in.)
- B: 100 mm (3.93 in.)
- C: 20 mm (0.78 in.)
- D: 70 mm (2.75 in.)

I037877E02

WW

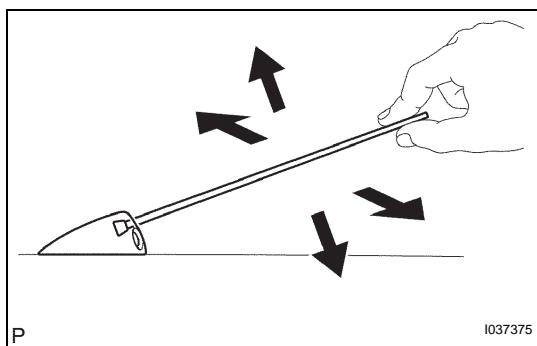

**2. ADJUST WASHER NOZZLE**

- (a) Using a pin, adjust the direction of the washer nozzle.

**NOTICE:**

**Use a pin that the end is not sharp.**