

# REAR WIPER MOTOR

## COMPONENTS

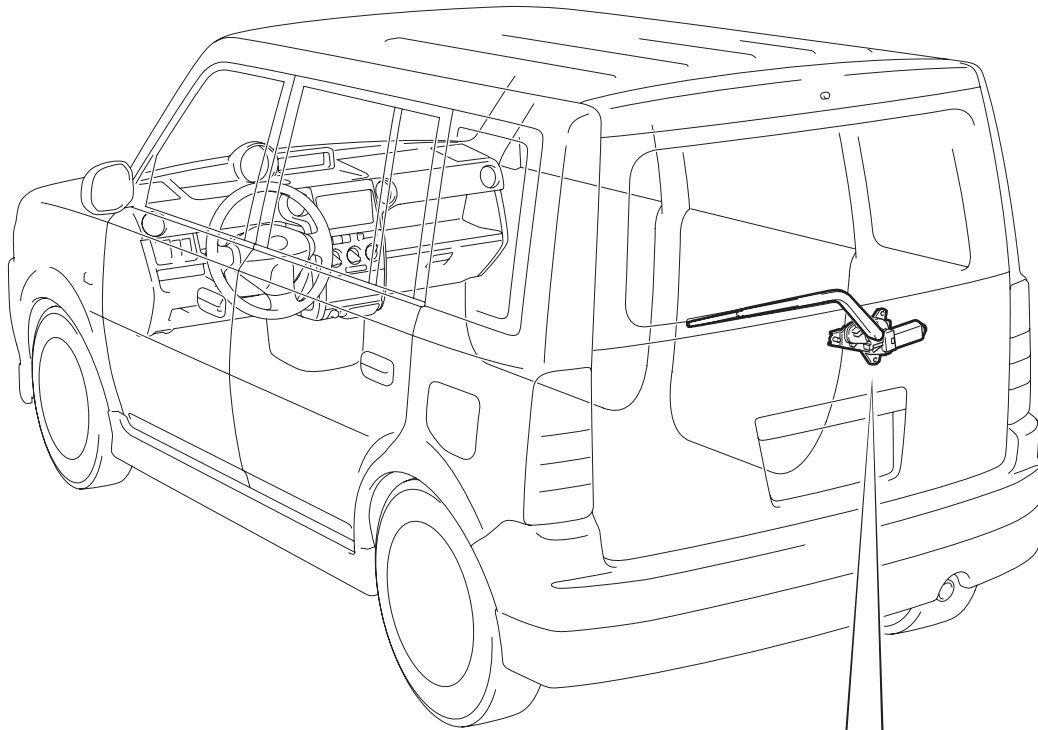

WW

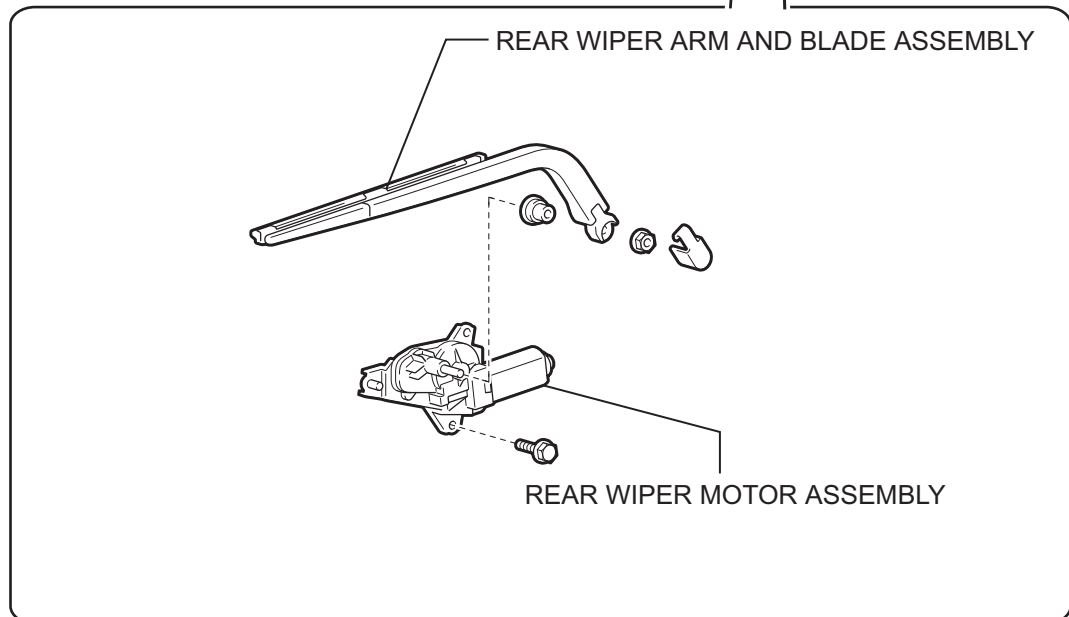

## REMOVAL

1. DISCONNECT CABLE FROM NEGATIVE BATTERY TERMINAL

**CAUTION:**

Wait at least 90 seconds after disconnecting the cable from the negative (-) battery terminal to prevent airbag and seat belt pretensioner activation.

2. REMOVE BACK DOOR TRIM BOARD (See page ED-38)

3. REMOVE REAR WIPER ARM AND BLADE ASSEMBLY

- (a) Detach the 2 claws and open the cover.
- (b) Remove the nut and rear wiper arm.

4. REMOVE REAR WIPER MOTOR GROMMET

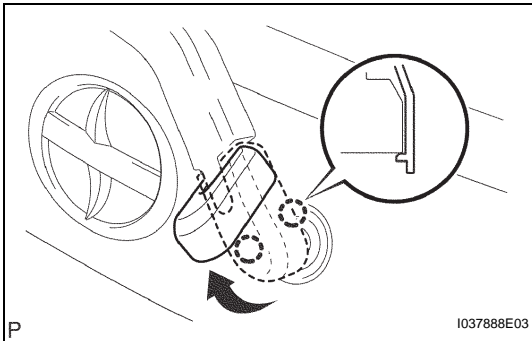

5. REMOVE REAR WIPER MOTOR ASSEMBLY

- (a) Disconnect the connector.
- (b) Remove the 3 bolts and rear wiper motor.

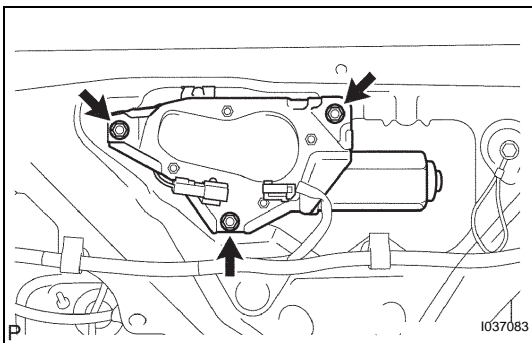

## INSPECTION

1. INSPECT REAR WIPER MOTOR ASSEMBLY

- (a) Check operation.
  - (1) Connect the battery's positive (+) lead to terminal 1 of the connector and the negative (-) lead to terminal 2, and check that the rear wiper motor operates.

**NOTICE:**

The body earth should be connected.

- (b) Check automatic stop position operation.
  - (1) Connect the battery's positive (+) lead to terminal 1 and negative (-) lead to terminal 2.

**NOTICE:**

The body earth should be connected.

- (2) With the motor being rotated, disconnect terminal 1 (+B) and terminal 3 (+1) to stop the motor operation at any position other than the automatic stop position.
- (3) Connect the battery's positive (+) lead to terminal 1. Check that the motor is restarted and automatically stops.

