

# FRONT WIPER MOTOR AND LINK

## COMPONENTS

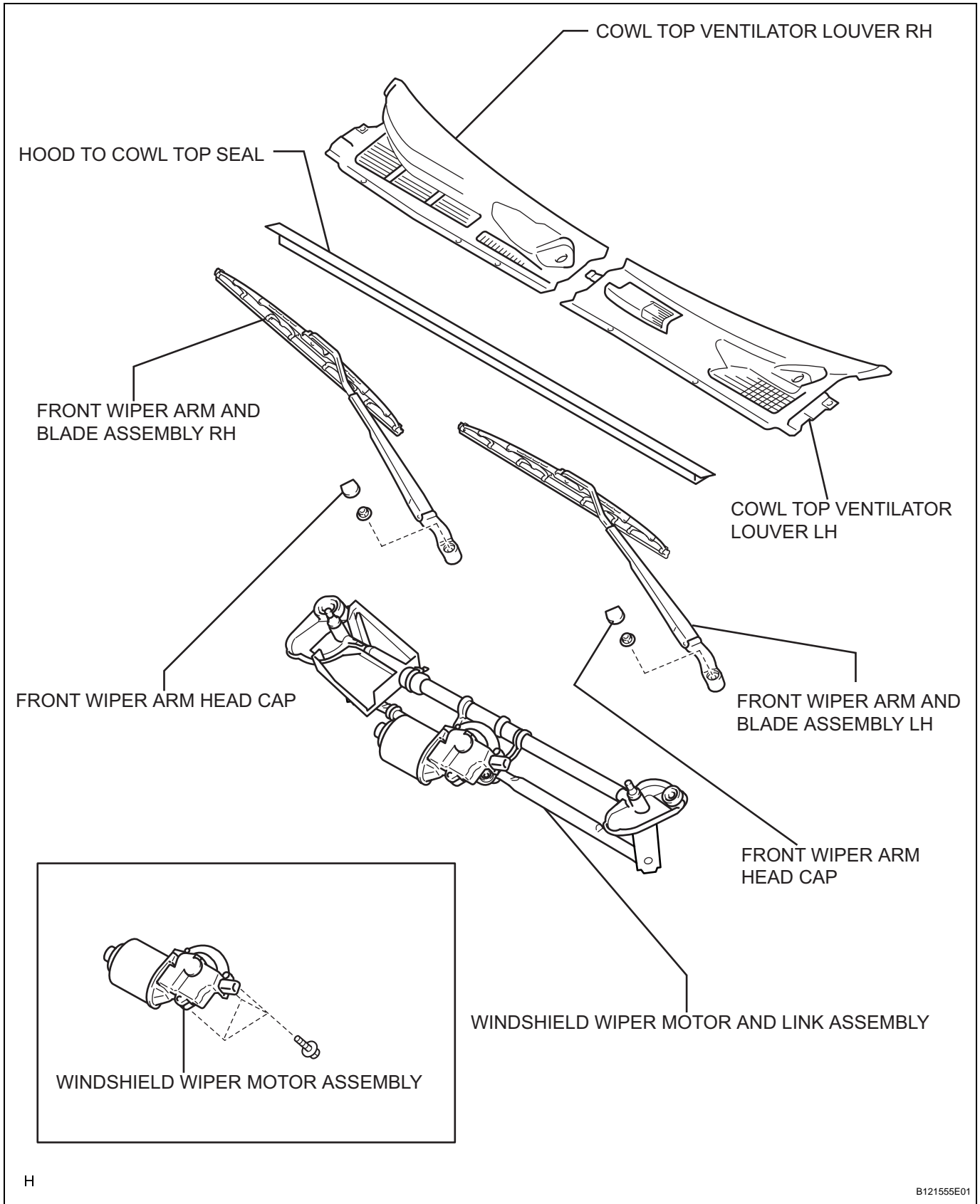



## REMOVAL

1. **DISCONNECT CABLE FROM NEGATIVE BATTERY TERMINAL**

**CAUTION:**

Wait at least 90 seconds after disconnecting the cable from the negative (-) battery terminal to prevent airbag and seat belt pretensioner activation.

2. **REMOVE FRONT WIPER ARM HEAD CAP**
3. **REMOVE FRONT WIPER ARM AND BLADE ASSEMBLY RH**
4. **REMOVE FRONT WIPER ARM AND BLADE ASSEMBLY LH**
5. **REMOVE HOOD TO COWL TOP SEAL**
  - (a) Using a clip remover, remove the 5 clips and seal.

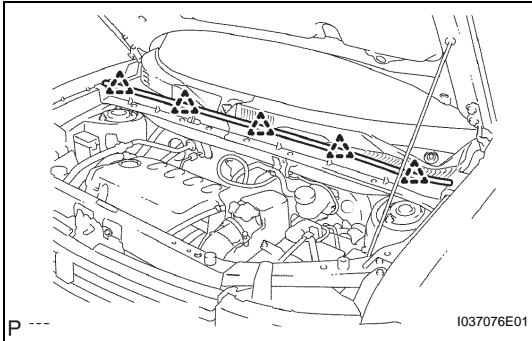

6. **REMOVE COWL TOP VENTILATOR LOUVER RH**

- (a) Using a clip remover, remove the 4 clips.
- (b) Detach the 5 claws and remove the ventilator louver.

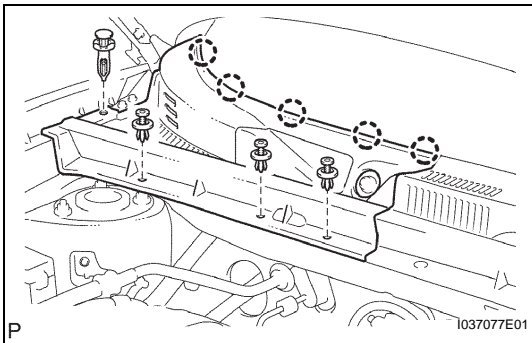

7. **REMOVE COWL TOP VENTILATOR LOUVER LH**

- (a) Using a clip remover, remove the 4 clips.
- (b) Detach the 5 claws and remove the ventilator louver.

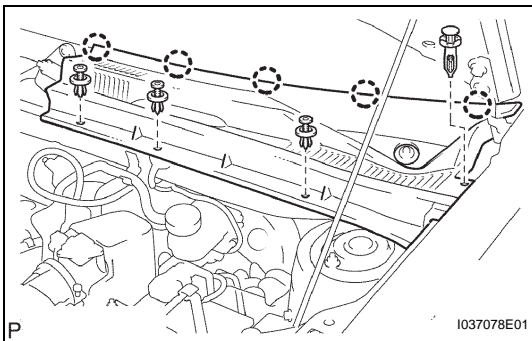

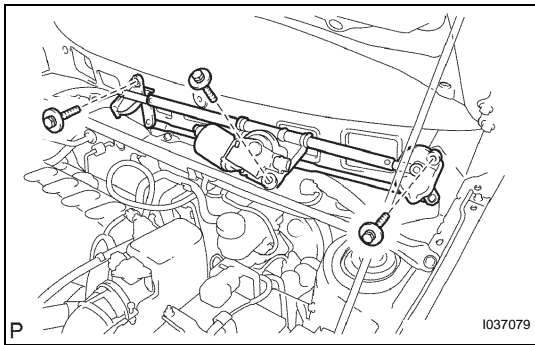

- 8. REMOVE WINDSHIELD WIPER MOTOR AND LINK ASSEMBLY**
- (a) Disconnect the connector.
  - (b) Remove the 3 bolts and the wiper motor and link.

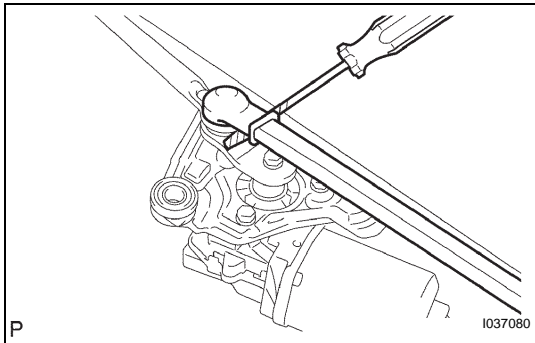

- 9. REMOVE WINDSHIELD WIPER MOTOR ASSEMBLY**

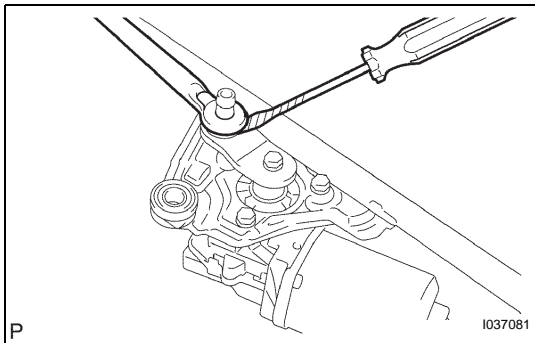

- (a) Using a screwdriver, disconnect the 2 rods at the crank arm pivot of the wiper motor.  
**HINT:**  
 Tape the screwdriver tip before use to avoid damage.

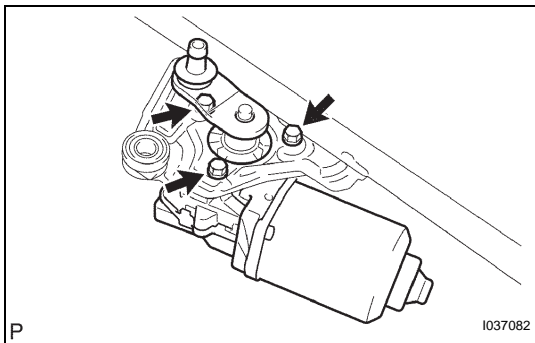

- (b) Remove the 3 bolts and the wiper motor.

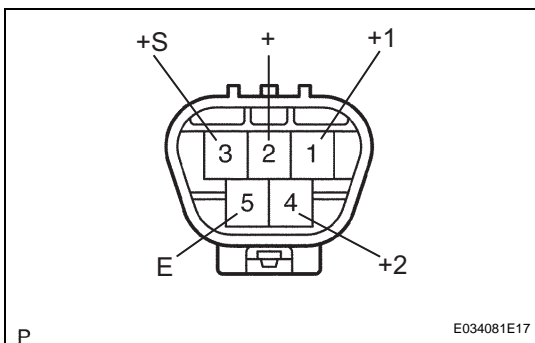

**INSPECTION**

- 1. INSPECT WINDSHIELD WIPER MOTOR ASSEMBLY**
- (a) Check the LO operation
    - (1) Connect the battery's positive (+) lead to terminal 1 (+1) and the negative (-) lead to terminal 5 (E), and check that the motor operates at low speed (LO).
- OK:**  
**Motor operates at low speed (LO).**





- (b) Check the HI operation.
  - (1) Connect the battery's positive (+) lead to terminal 4 (+2) and the negative lead to terminal 5 (E), and check that the motor operates at high speed (HI).
 

**OK:**  
**Motor operates at high speed (HI).**
- (c) Check the automatic stop operation.
  - (1) Connect the battery's positive (+) lead to terminal 1 (+1) and the negative (-) lead to terminal 5 (E). With the motor rotating at low speed (LO), disconnect terminal 1 (+1) to stop the wiper motor operation at any position other than the automatic stop position.
  - (2) Using SST, connect terminal 1 (+1) and 3 (S). Then connect the battery's positive (+) lead to terminal 2 (+) to restart the motor operation at low speed (LO).
 

**SST 09843-18040**
  - (3) Check that the motor stops automatically at the automatic stop position.
 

**OK:**  
**Refer to illustration on left.**  
**If the result is not as specified, replace the motor assembly.**

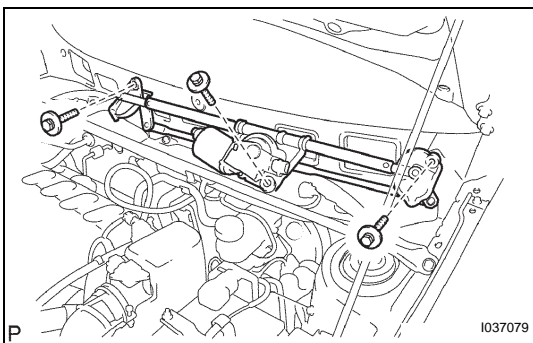
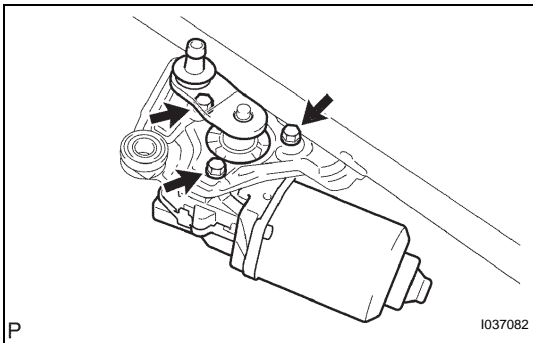
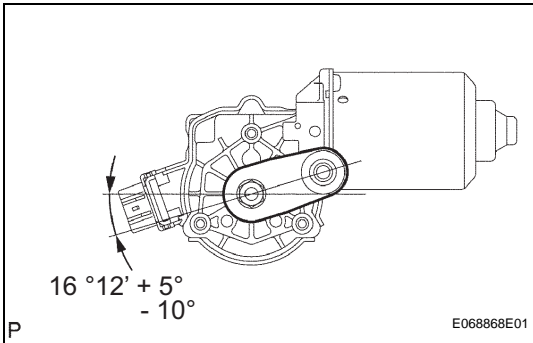

## INSTALLATION

### 1. INSTALL WINDSHIELD WIPER MOTOR ASSEMBLY

- (a) Install the wiper motor to the wiper link with the 3 bolts.
 

**Torque: 5.4 N\*m (55 kgf\*cm, 47 in.\*lbf)**
- (b) Apply grease to the crank arm pivot of the wiper motor.
- (c) Install the 2 rods to the wiper motor.

### 2. INSTALL WINDSHIELD WIPER MOTOR AND LINK ASSEMBLY

- (a) Install the wiper motor and link with the 3 bolts.
 

**Torque: 5.4 N\*m (55 kgf\*cm, 47 in.\*lbf)**
- (b) Connect the connector.

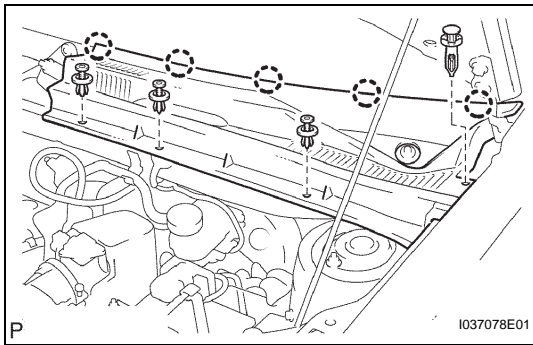

**3. INSTALL COWL TOP VENTILATOR LOUVER LH**

- (a) Attach the 5 claws to install the ventilator louver.
- (b) Install the 4 clips.

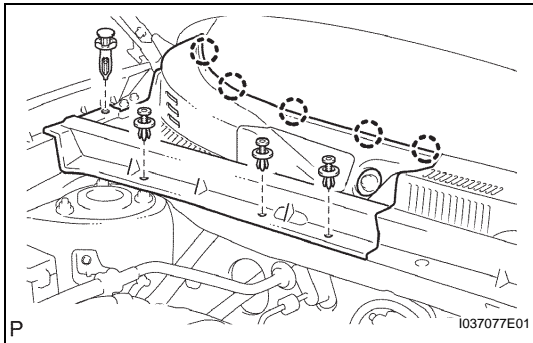

**4. INSTALL COWL TOP VENTILATOR LOUVER RH**

- (a) Attach the 5 claws to install the ventilator louver.
- (b) Install the 4 clips.

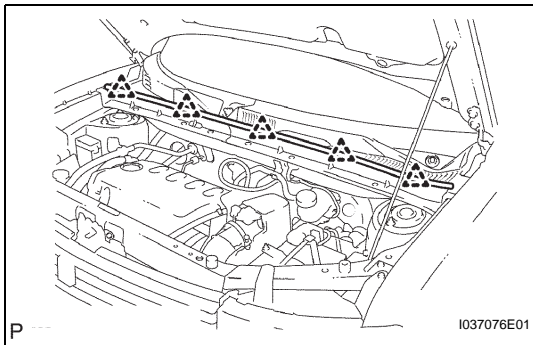

**5. INSTALL HOOD TO COWL TOP SEAL**

- (a) Attach the 5 clips to install the seal.

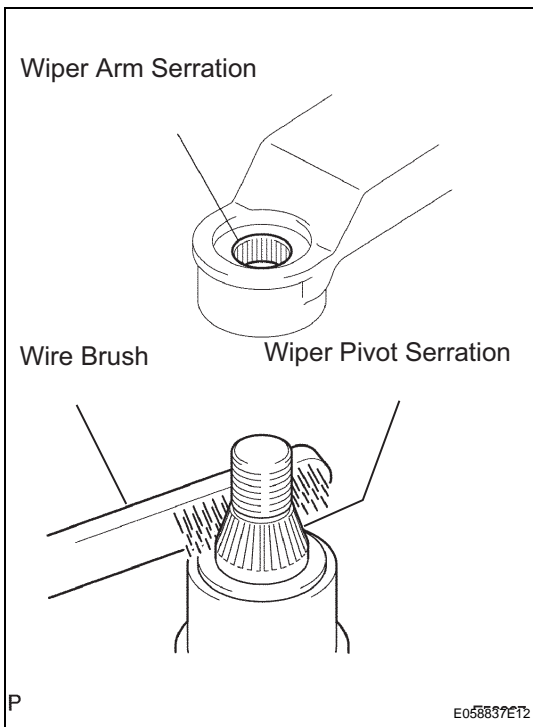

**6. INSTALL FRONT WIPER ARM AND BLADE ASSEMBLY LH**

- (a) Operate the wiper, and stop the windshield wiper motor at the automatic stop position.
- (b) Scrape off the serration part of the wiper arm with a round file or equivalent.
- (c) Clean the wiper pivot serration with a wire brush.



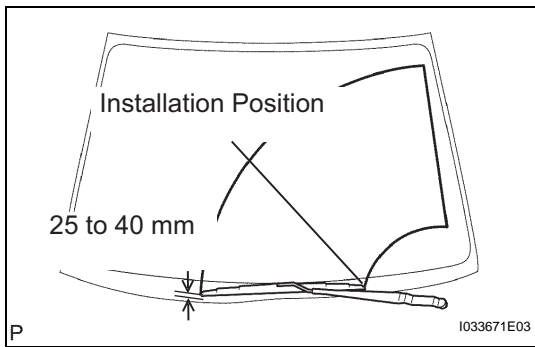

- (d) Install the wiper arm and blade with the nut in the position shown in the illustration.

**Torque: 20 N\*m (205 kgf\*cm, 15 ft.\*lbf)**

**Installation position mark:**

**25 to 40 mm (0.98 to 1.57 in.)**

**HINT:**

Hold down the arm hinge by hand in order to fasten the nut.

- (e) Operate the wiper while running water or washer fluid over the window, and check the wiping condition and that the rear wiper does not hit against the vehicle's body.

WW

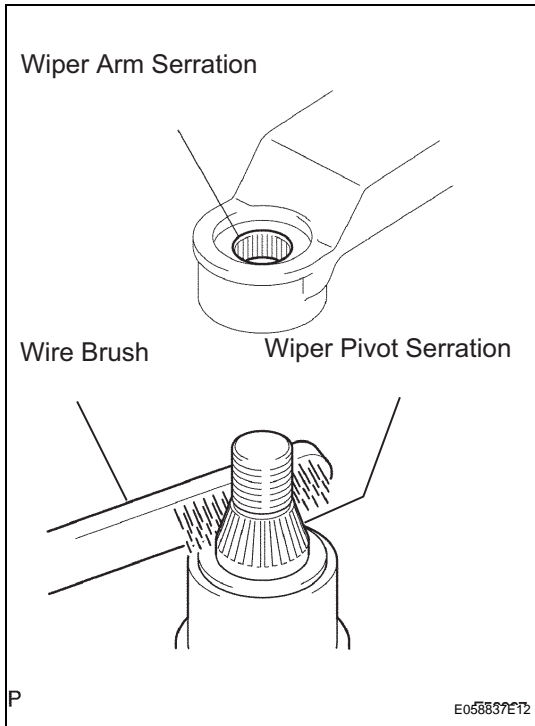

**7. INSTALL FRONT WIPER ARM AND BLADE ASSEMBLY RH**

- (a) Operate the wiper, and stop the wiper motor at the automatic stop position.
- (b) Scrape off the serration part of the wiper arm with a round file or equivalent.
- (c) Clean the wiper pivot serration with a wire brush.

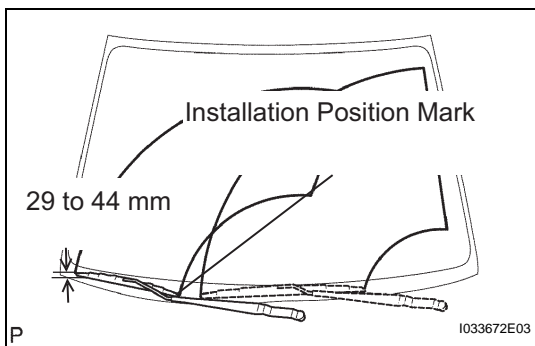

- (d) Install the wiper arm and blade with a nut in the position shown in the illustration.

**Torque: 20 N\*m (205 kgf\*cm, 15 ft.\*lbf)**

**Installation position mark:**

**29 to 44 mm (1.14 to 1.73 in.)**

**HINT:**

Hold down the arm hinge by hand in order to fasten the nut.

**8. INSTALL WINDSHIELD WIPER ARM HEAD CAP**

**9. CONNECT CABLE TO NEGATIVE BATTERY TERMINAL**