

ADJUSTMENT

HINT:

- Centering bolts are used to mount the door hinge to the vehicle body and door. The door cannot be adjusted with the centering bolts on. Substitute the centering bolts with standard bolts (w/ washers) when making adjustments.
- A bolt without a torque specification is shown in the standard bolt chart (see page [SS-2](#)).

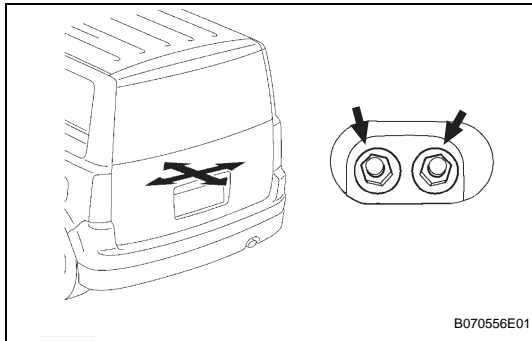
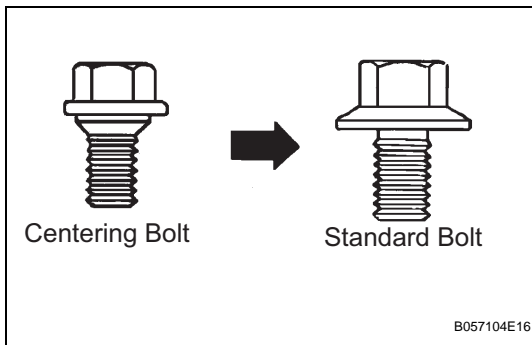

1. DOOR PANEL SUB-ASSEMBLY

- Remove the roof headlining (see page [IR-6](#)).
- As shown in the illustration, horizontally and vertically adjust the door by loosening the body side hinge nuts.
- Tighten the body side hinge nuts after the adjustment.

Torque: 26 N*m (265 kgf*cm, 19 ft.*lbf)

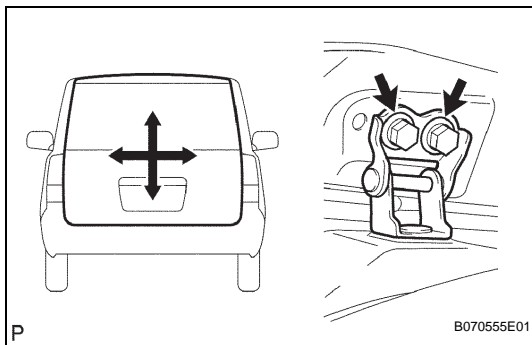

- Horizontally and vertically adjust the door by loosening the door side hinge bolts.
- Tighten the door side hinge bolts after the adjustment.

Torque: 26 N*m (265 kgf*cm, 19 ft.*lbf)

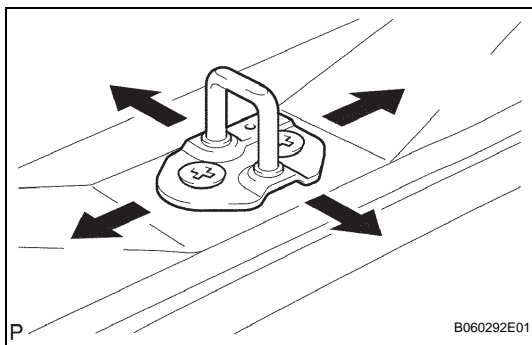

- Remove the deck trim cover rear (see page [IR-7](#)).
- Adjust the striker position by slightly loosening the striker mounting screws and hitting the striker with a plastic-faced hammer.
- Tighten the striker mounting screws after the adjustment.

Torque: 11.5 N*m (120 kgf*cm, 8 ft.*lbf)

REASSEMBLY

HINT:

A bolt without a torque specification is shown in the standard bolt chart (see page [SS-2](#)).

1. **INSTALL BACK DOOR STOPPER LOWER**
 - (a) Install the stopper LH and RH with the bolt.
Torque: 12.5 N*m (112 kgf*cm, 9 ft.*lbf)
2. **INSTALL BACK DOOR STAY SUB-ASSEMBLY LH**
(See page [ED-42](#))
3. **INSTALL BACK DOOR STAY SUB-ASSEMBLY RH**
 - (a) Use the same procedures described for the LH side.
4. **INSTALL DOOR PULL HANDLE**
 - (a) Attach the 4 claws and install the pull handle.
5. **INSTALL BACK WINDOW GLASS CHANNEL LH**
 - (a) Clean the contact surface of the door with a sponge saturated with white gasoline.
 - (b) Using a heat light, heat the door and new channel.
Standard heating temperature

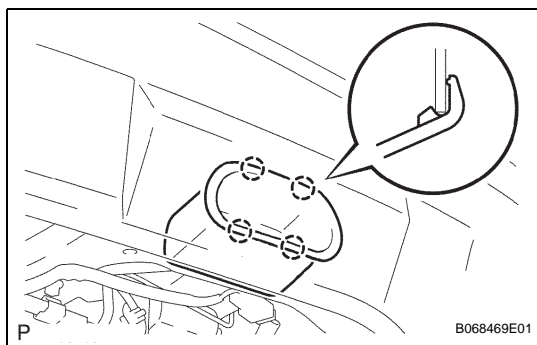

Item	Specified Condition
Door	40 to 60°C (104 to 140°F)
Channel	20 to 30°C (68 to 86°F)

NOTICE:

Do not heat the door and channel excessively.

- (c) Remove peeling paper from the channel face.
 - (d) Install the channel and 2 clips.
6. **INSTALL BACK WINDOW GLASS CHANNEL RH**
 - (a) Use the same procedures described for the LH side.
7. **INSTALL BACK DOOR LOCK ASSEMBLY**
 - (a) Install the door lock with the 3 bolts.
Torque: 12.5 N*m (112 kgf*cm, 9 ft.*lbf)
 - (b) Connect the door lock connector.
8. **INSTALL REAR WIPER MOTOR ASSEMBLY** (See page [WW-17](#))
9. **INSTALL CENTER STOP LIGHT ASSEMBLY** (See page [LI-20](#))
10. **INSTALL BACK DOOR GARNISH OUTSIDE** (See page [ET-24](#))
11. **INSTALL BACK DOOR TRIM BOARD**
 - (a) Install the trim board with the 11 clips.
12. **CONNECT CABLE TO NEGATIVE BATTERY TERMINAL**

