

ON-VEHICLE INSPECTION

1. CHECK AIR-FUEL RATIO COMPENSATION SYSTEM

HINT:

The system can also be checked by choosing "DATA MONITOR/O₂SENSOR OUTPUT VOLTAGE" on the intelligent tester monitor.

- (a) Connect the intelligent tester to terminals E5-25 (OX1B) and E5-28 (E2) of the ECM.

NOTICE:

Connect test leads from the backside of the connector with the ECU connected.

- (b) Warm up the heated oxygen sensor at an engine speed of 2,500 rpm for approximately 2 minutes.
- (c) Check that the voltage varies between approximately 0 V and 1 V at an engine speed of 2,500 rpm.

OK:

The voltage varies more than 8 times in 10 seconds.

NOTICE:

- Perform the check immediately after warming up the heated oxygen sensor.
- If the voltage variation could not be verified, warm up the heated oxygen sensor again.

2. INSPECT HEATED OXYGEN SENSOR

- (a) Disconnect the sensor connector.
- (b) Measure the resistance of the sensor.

Standard resistance

Tester Connection	Specified Condition
1 (HT) - 2 (+B)	11 to 16 Ω at 20°C (68°F)
1 (HT) - 4 (E1)	10 kΩ or higher

If the result is not as specified, replace the sensor.

- (c) Connect the sensor connector.

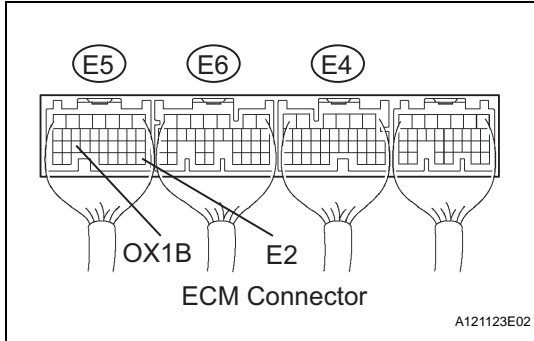

EC

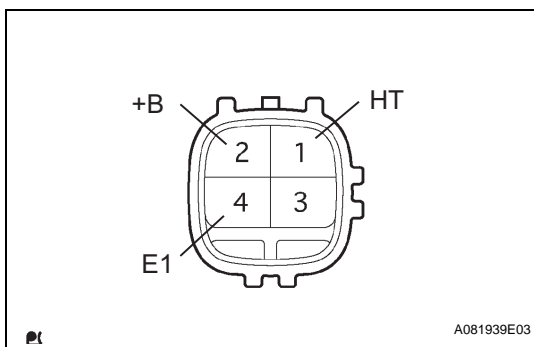

REMOVAL

1. DISCONNECT CABLE FROM NEGATIVE BATTERY TERMINAL

CAUTION:

Wait at least 90 seconds after disconnecting the cable from the negative (-) battery terminal to prevent airbag and seat belt pretensioner activation.

2. REMOVE SHIFT LEVER KNOB (for Manual Transaxle)
3. REMOVE REAR CONSOLE BOX (See page [IP-29](#))
4. REMOVE HEATED OXYGEN SENSOR
 - (a) Disconnect the sensor connector.

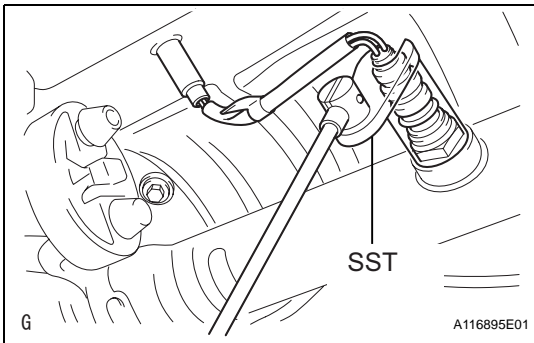
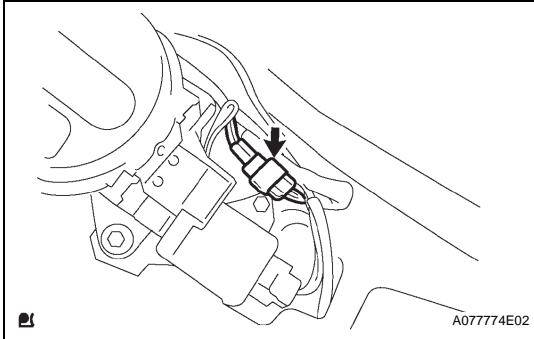

- (b) Using SST, remove the sensor.
SST 09224-00010

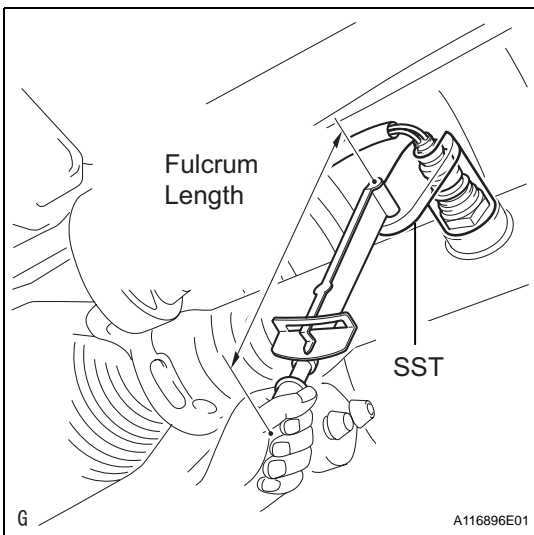

INSTALLATION

1. INSTALL HEATED OXYGEN SENSOR

- (a) Using SST, install the sensor.

SST 09224-00010

Torque: 44 N*m (449 kgf*cm, 32 ft.*lbf) for use with SST

40 N*m (408 kgf*cm, 30 ft.*lbf) for use without SST

HINT:

Use a torque wrench with a fulcrum length of 30 cm (11.81 in.).

- (b) Connect the sensor connector.

2. INSTALL REAR CONSOLE BOX (See page [IP-30](#))
3. INSTALL SHIFT LEVER KNOB (for Manual Transaxle)
4. CONNECT CABLE TO NEGATIVE BATTERY TERMINAL
5. CHECK FOR EXHAUST GAS LEAKS

If gas is leaking, tighten the problem areas to stop the leak. Replace damaged parts as necessary.