

## REMOVAL

1. **DISCHARGE FUEL SYSTEM PRESSURE** (See page [FU-11](#))
2. **DISCONNECT CABLE FROM NEGATIVE BATTERY TERMINAL**  
**CAUTION:**  
Wait at least 90 seconds after disconnecting the cable from the negative (-) battery terminal to prevent airbag and seat belt pretensioner activation.
3. **REMOVE REAR SEAT CUSHION ASSEMBLY** (See page [SE-12](#))
4. **REMOVE REAR SEAT CUSHION SUPPORT BRACKET** (See page [FU-18](#))
5. **REMOVE REAR FLOOR SERVICE HOLE COVER** (See page [FU-18](#))
6. **REMOVE FUEL PUMP TUBE SUB-ASSEMBLY** (See page [FU-19](#))
7. **REMOVE NO. 2 FUEL EVAPORATION TUBE SUB-ASSEMBLY** (See page [FU-19](#))
8. **REMOVE EXHAUST PIPE ASSEMBLY**
  - (a) Remove the exhaust pipe assembly (see page [EX-3](#)).
9. **DRAIN FUEL**
10. **DISCONNECT NO. 2 PARKING BRAKE CABLE ASSEMBLY**
  - (a) Remove the 2 bolts and disconnect the cable clamp as shown in illustration A below.
11. **DISCONNECT NO. 3 PARKING BRAKE CABLE ASSEMBLY**
  - (a) Remove the 2 bolts and disconnect the cable clamp as shown in illustration B below.
12. **REMOVE NO. 1 FUEL TANK PROTECTOR**
  - (a) Remove the 2 clips, fuel tank protector bracket and protector as shown in illustration G below.
13. **REMOVE FUEL TANK ASSEMBLY**
  - (a) Disconnect the fuel tank to filler pipe hose from the fuel tank as shown in illustration C below.
  - (b) Disconnect the fuel vapor hose from the fuel tank as shown in illustration C below.
  - (c) Disconnect the fuel tank vent hose from the canister as shown in illustration D below.  
**HINT:**  
Pull up the retainer and pull out the vent hose.

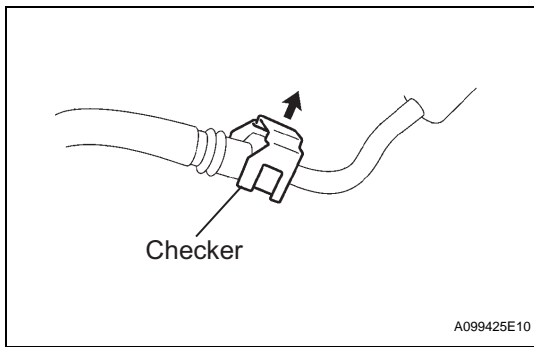

- (d) Disconnect the fuel pump tube as shown in illustration E below.
- (1) Disengage the lock claw by lifting up the checker, as shown in the illustration.

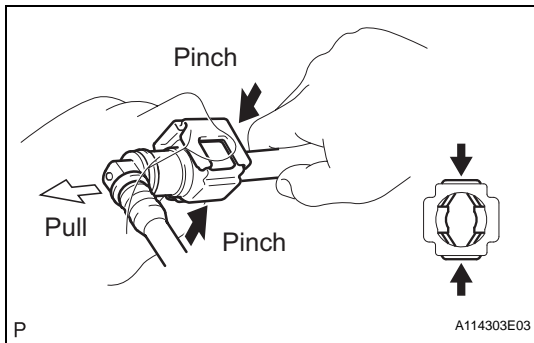

- (2) Check for dirt or mud on the pipe and around the connector before disconnection. Clean as necessary.
- (3) Disconnect the connector and pipe by hand.
- (4) If the connector and the pipe are stuck, pinch the connector, and push and pull the pipe to disconnect it.

**NOTICE:**  
**Do not use any tools.**

- (5) Check for dirt or mud on the seal surface of the disconnected pipe. Clean as necessary.
- (6) To protect the disconnected pipe and connector from damage and contamination, cover it with a plastic bag.

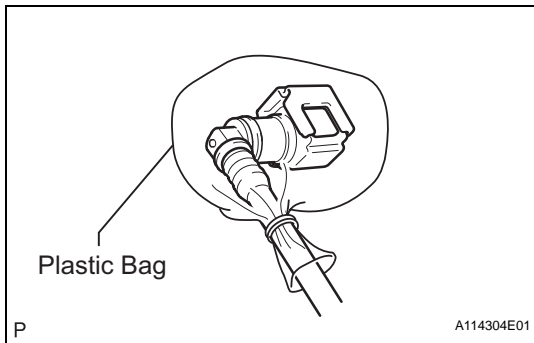

- 
- (e) Remove the 4 bolts and fuel tank as shown in illustration A, B, C and F below.

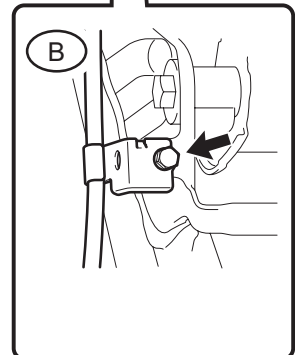
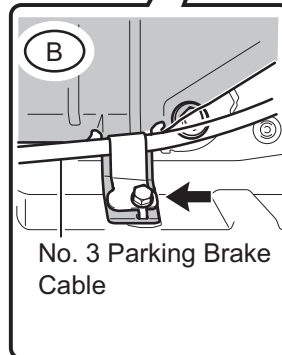
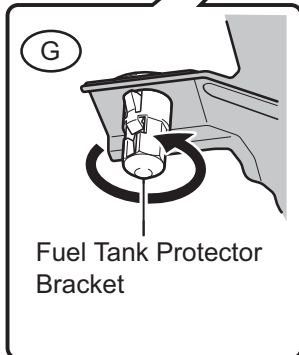
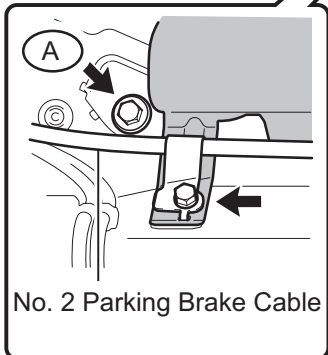
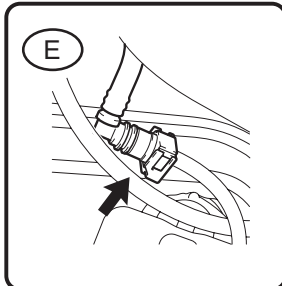
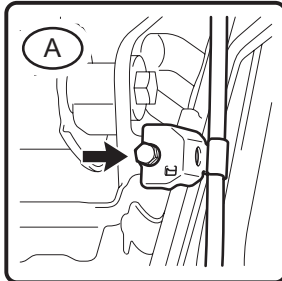
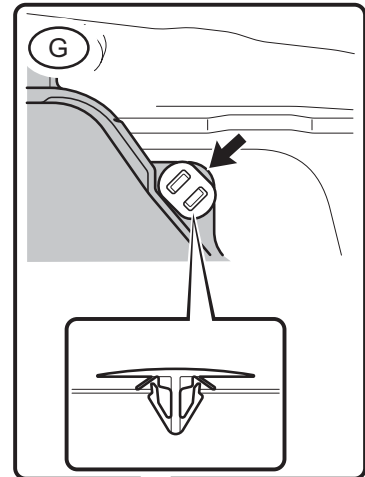
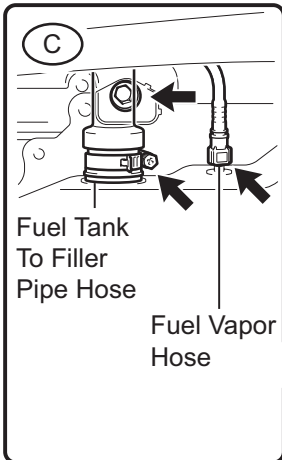
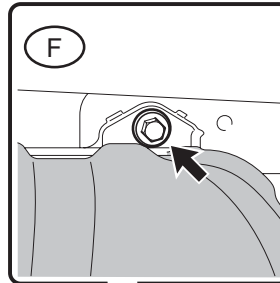
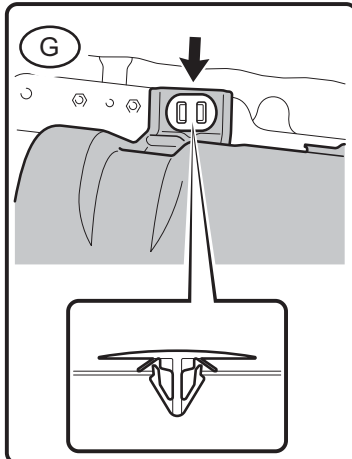
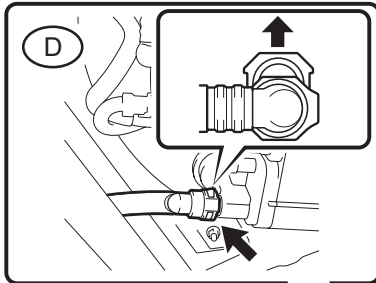

FU

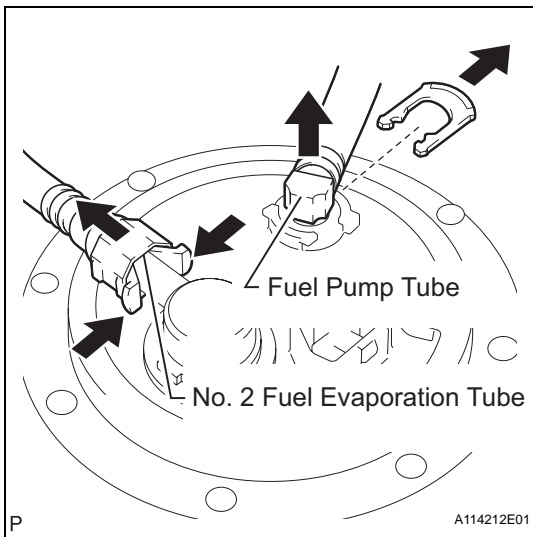
**14. REMOVE FUEL PUMP TUBE SUB-ASSEMBLY**

- (a) Remove the tube joint clip, and then pull out the pump tube (see page [FU-19](#)).

**15. REMOVE NO. 2 FUEL EVAPORATION TUBE SUB-ASSEMBLY**

- (a) Pinch the No. 2 fuel evaporation tube clip, and then pull out the No. 2 fuel evaporation tube (see page [FU-19](#)).

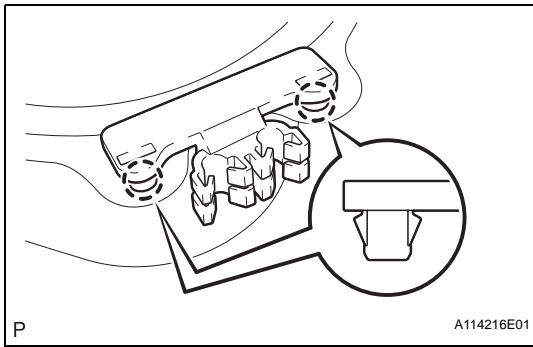
**16. REMOVE NO. 3 FUEL TUBE CLAMP**

- (a) Detach the 2 claws and remove the clamp.

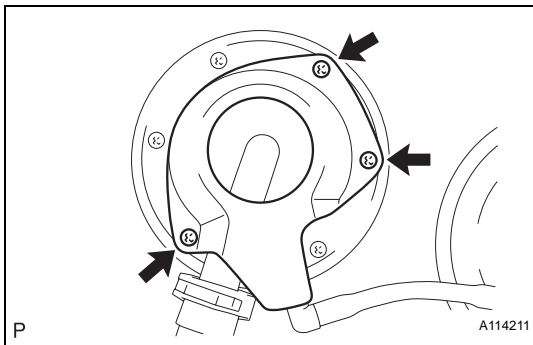
**17. REMOVE CHECK VALVE PROTECTOR**

- (a) Remove the 3 bolts and protector.

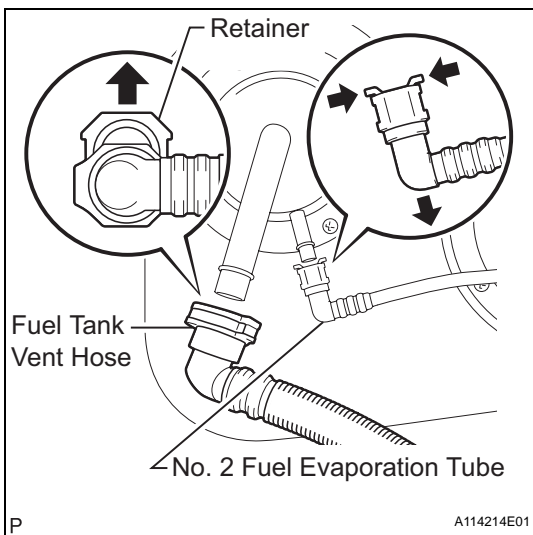
**18. REMOVE NO. 2 FUEL EVAPORATION TUBE SUB-ASSEMBLY**

- (a) Pinch the tube connector clip, and then pull out the evaporation tube.

**19. REMOVE FUEL TANK VENT HOSE**

- (a) Pull up the retainer and pull out the vent hose.

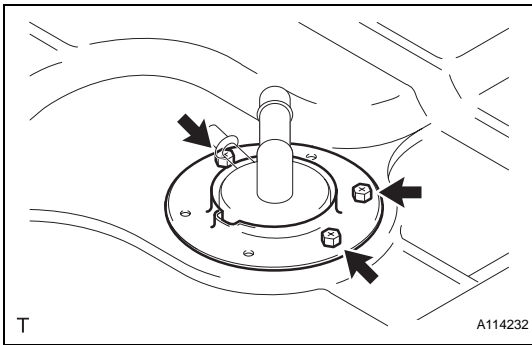
**20. REMOVE CHECK VALVE SUPPORT**

- (a) Remove the 3 bolts and valve support.

**21. REMOVE FUEL TANK INLET VALVE ASSEMBLY**

- (a) Remove the inlet valve from the fuel tank.

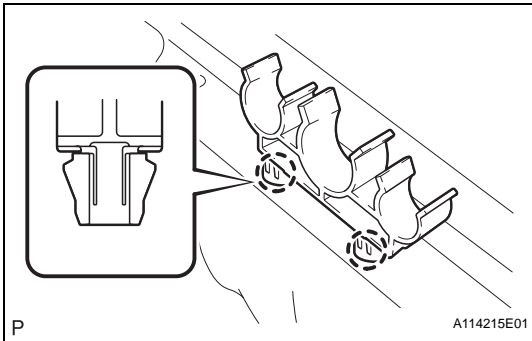
**22. REMOVE NO. 1 FUEL TUBE CLAMP**

- (a) Detach the 2 claws and remove the clamp.

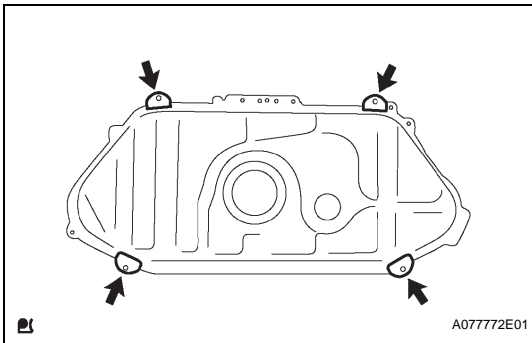
**23. REMOVE FUEL TANK SIDE PLATE**

- (a) Remove the side 4 plates from the fuel tank.

**24. REMOVE FUEL TANK TO FILLER PIPE HOSE**

- (a) Loosen the clamp.  
 (b) Remove the hose from the fuel tank inlet pipe.

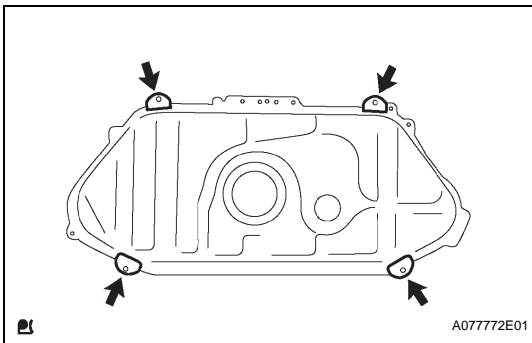
**INSTALLATION****1. INSTALL FUEL TANK SIDE PLATE**

- (a) Install the side 4 plates to the fuel tank.

**2. INSTALL NO. 1 FUEL TUBE CLAMP**

- (a) Attach the clamp to the fuel tank.

**3. INSTALL FUEL TANK INLET VALVE ASSEMBLY**

- (a) Install a new gasket and the inlet valve to the fuel tank.

**NOTICE:**

**When removing or installing the fuel tank inlet valve, be careful as it is made from resin and will be easily damaged.**

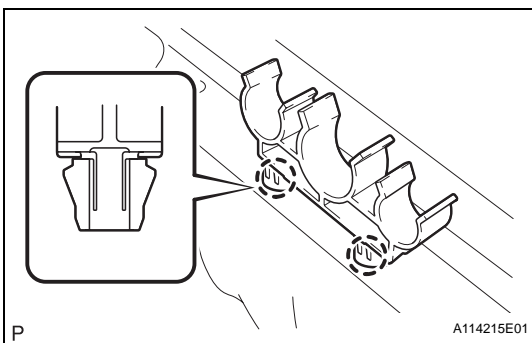

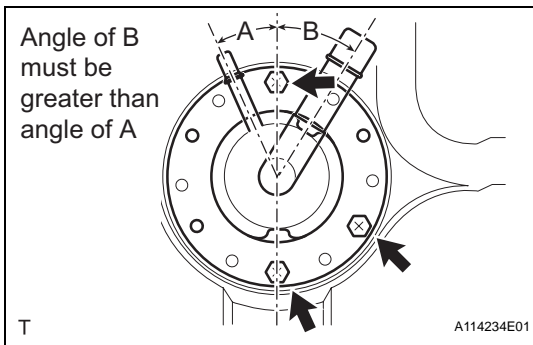

#### 4. INSTALL CHECK VALVE SUPPORT

- (a) Install the valve support with the 3 bolts as shown in the illustration.

**Torque: 3.5 N\*m (36 kgf\*cm, 31 in.\*lbf)**

HINT:

- Angle of A: Approximately 20°
- Angle of B: Approximately 25°

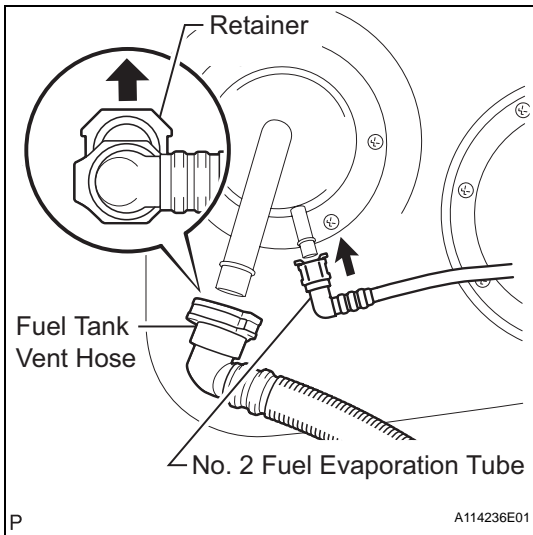

#### 5. INSTALL FUEL TANK VENT HOSE

- (a) Pull up the retainer and install the vent hose.  
 (b) Connect the retainer.

#### 6. INSTALL NO. 2 FUEL EVAPORATION TUBE SUB-ASSEMBLY

- (a) Install the No. 2 fuel evaporation tube.

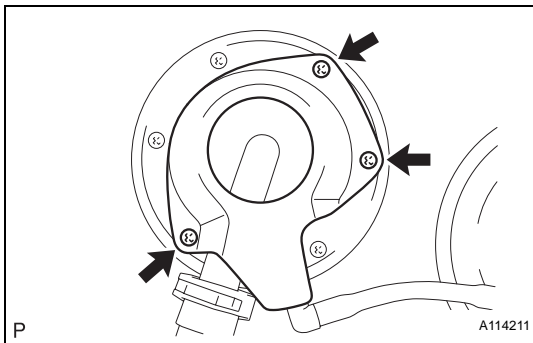

#### 7. INSTALL CHECK VALVE PROTECTOR

- (a) Install the protector with the 3 bolts.  
**Torque: 3.5 N\*m (36 kgf\*cm, 31 in.\*lbf)**

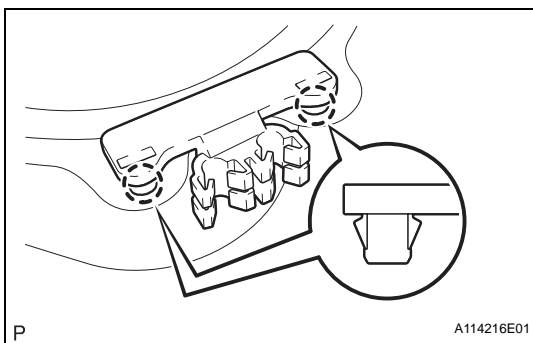

#### 8. INSTALL NO. 3 FUEL TUBE CLAMP

- (a) Attach the clamp to the fuel tank.

#### 9. INSTALL FUEL PUMP ASSEMBLY WITH FUEL SENDER GAUGE ASSEMBLY (See page [FU-23](#))

#### 10. CONNECT NO. 2 FUEL EVAPORATION TUBE SUB-ASSEMBLY (See page [FU-23](#))

#### 11. INSTALL FUEL TANK VENT TUBE SET PLATE BOLT (See page [FU-24](#))

#### 12. CONNECT FUEL PUMP TUBE SUB-ASSEMBLY (See page [FU-24](#))

#### 13. INSTALL FUEL TANK ASSEMBLY

- (a) Install the fuel tank with the 4 bolts as shown in A, B, C and F in the illustration below.

**Torque: 14.3 N\*m (146 kgf\*cm, 11 ft.\*lbf)**

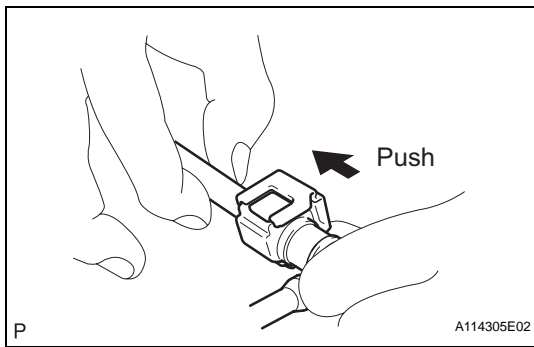

- (b) Connect the fuel pump tube as shown in illustration E below.
- (1) Check that there is no damage or contamination in the connected part of the pipe.
  - (2) Align the axis of the connector with the axis of the pipe, and push the pipe into the connector until the connector makes a "click" sound. If the connection is tight, apply a small amount of fresh engine oil to the tip of the pipe.

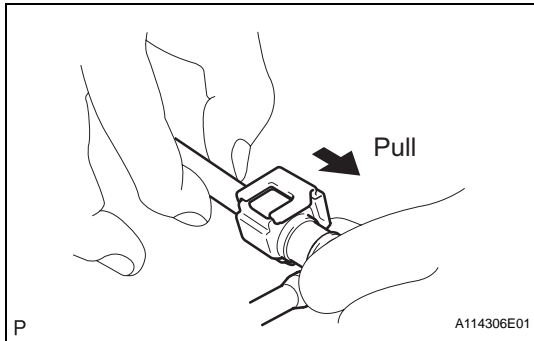

- (3) After having finished the connection, try to pull apart the pipe and the connector, and confirm that they are securely connected.

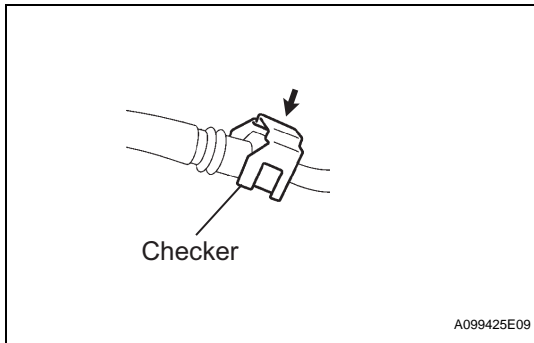

- (4) Attach the lock claws to the connector by pushing down on the checker, as shown in the illustration.
- (c) Connect the fuel tank vent hose to the canister (see page ) as shown in illustration D below.  
HINT:  
Pull up the retainer and install the vent hose, and then connect the retainer.
- (d) Connect the fuel vapor hose to the fuel tank as shown in illustration C below.

- (e) Connect a new fuel tank to filler pipe hose to the fuel tank and fuel inlet pipe as shown in illustration C below.
- (1) Tighten the 2 clamps of the fuel tank to filler pipe hose as shown in the illustration.

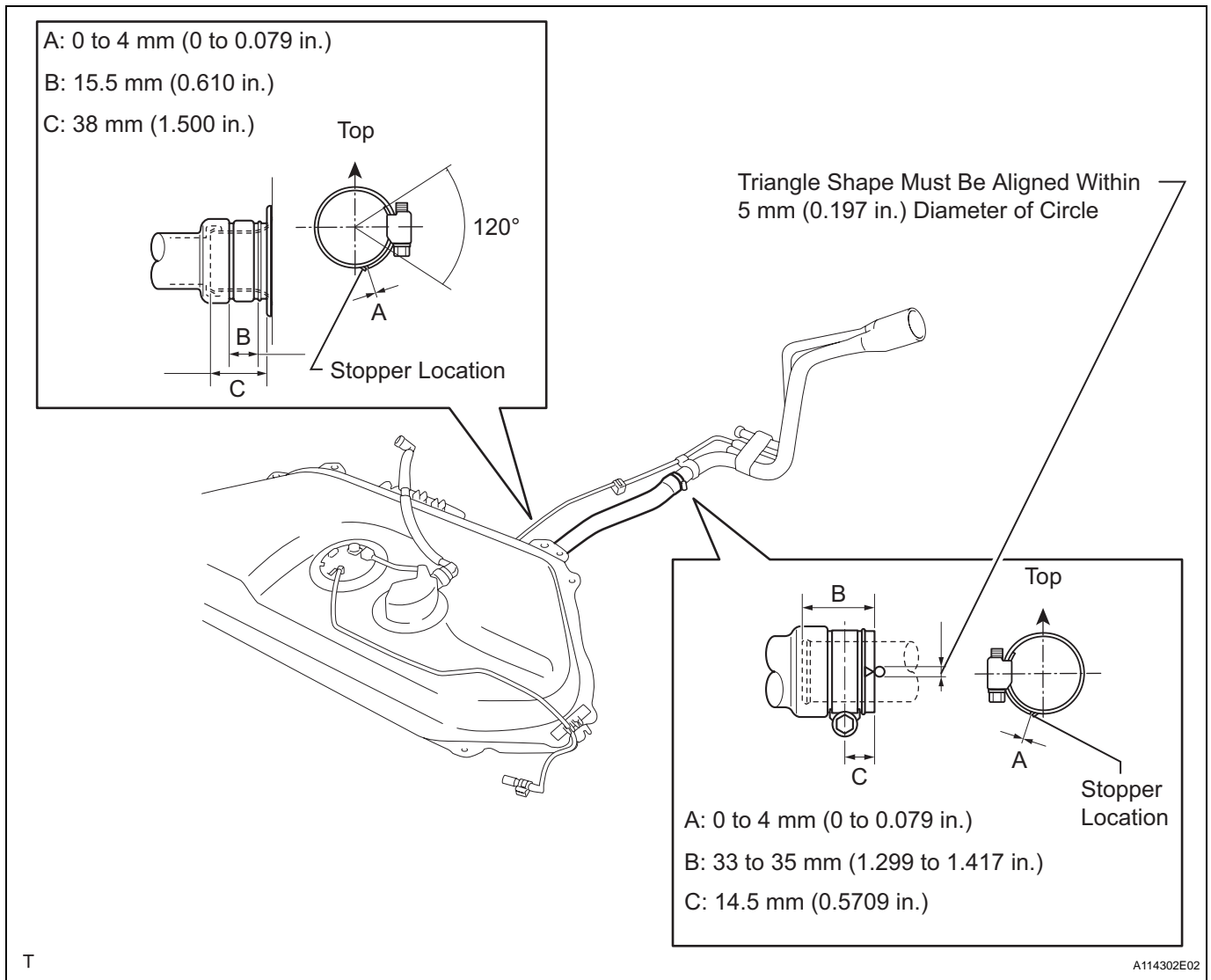

#### 14. INSTALL NO. 1 FUEL TANK PROTECTOR

- (a) Install the protector with the 2 clamps and fuel tank protector bracket as shown in illustration G below.

#### 15. CONNECT NO. 3 PARKING BRAKE CABLE ASSEMBLY

- (a) Connect the 2 cable clamps with the 2 bolts as shown in illustration B below.

**Torque: 5.4 N\*m (55 kgf\*cm, 48 in.\*lbf)**

#### 16. CONNECT NO. 2 PARKING BRAKE CABLE ASSEMBLY

- (a) Connect the 2 cable clamps with the 2 bolts as shown in illustration A below.

**Torque: 5.4 N\*m (55 kgf\*cm, 48 in.\*lbf)**

FU

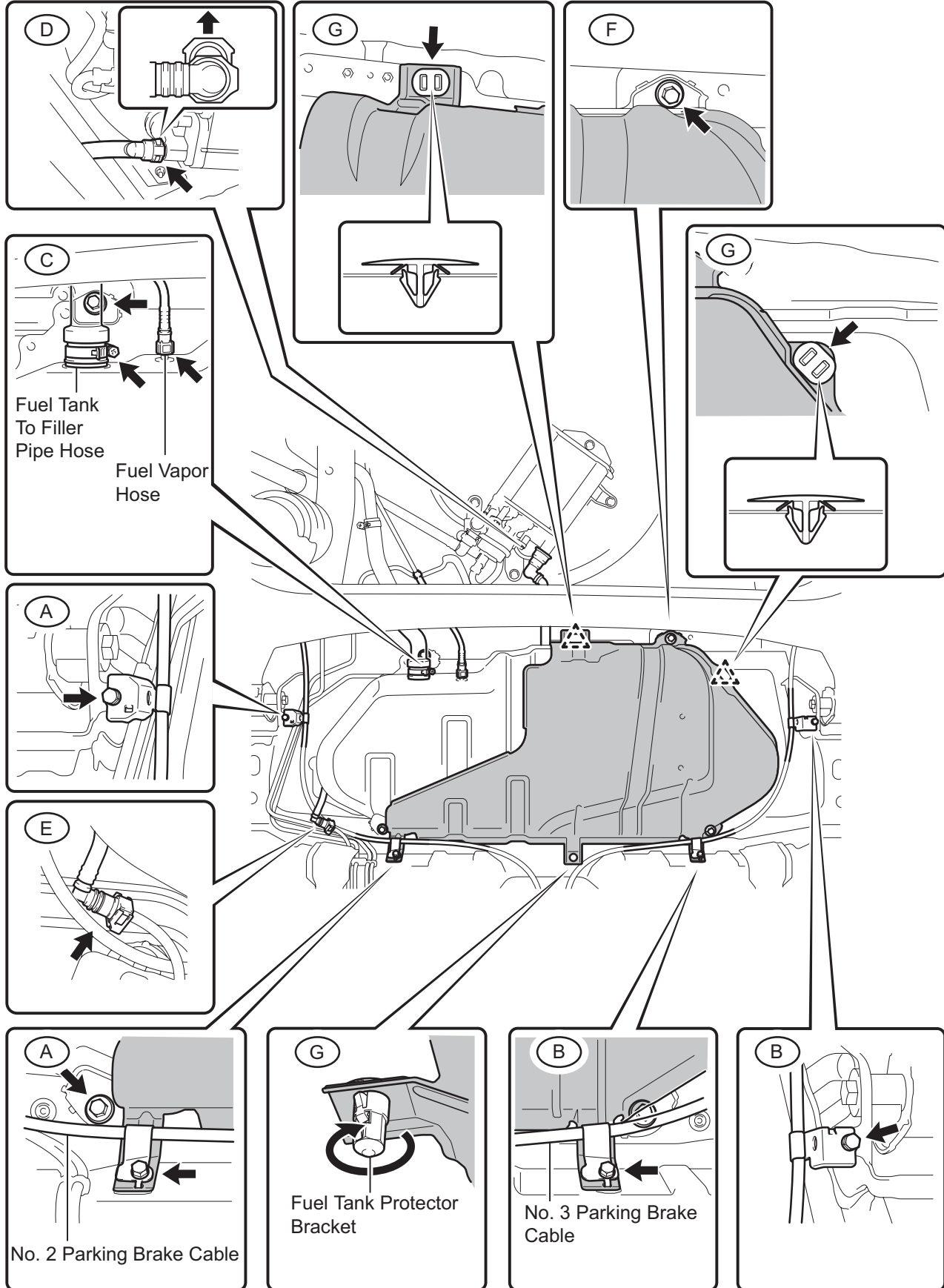

17. **INSTALL EXHAUST PIPE ASSEMBLY**
  - (a) Install the exhaust pipe (see page [EX-5](#)).
18. **CONNECT CABLE TO NEGATIVE BATTERY TERMINAL**
19. **ADD FUEL**
20. **CHECK FOR FUEL LEAKS (See page [FU-8](#))**
21. **INSTALL REAR FLOOR SERVICE HOLE COVER (See page [FU-24](#))**
22. **INSTALL REAR SEAT CUSHION SUPPORT BRACKET SUB-ASSEMBLY (See page [FU-24](#))**
23. **INSTALL REAR SEAT CUSHION ASSEMBLY (See page [SE-17](#))**
24. **CHECK FOR EXHAUST GAS LEAKS**