

## REMOVAL

1. **DISCHARGE FUEL SYSTEM PRESSURE** (See page [FU-11](#))
2. **DISCONNECT CABLE FROM NEGATIVE BATTERY TERMINAL**  
**CAUTION:**  
Wait at least 90 seconds after disconnecting the cable from the negative (-) battery terminal to prevent airbag and seat belt pretensioner activation.
3. **REMOVE REAR SEAT CUSHION ASSEMBLY** (See page [SE-12](#))
4. **REMOVE REAR SEAT CUSHION SUPPORT BRACKET**  
(a) Remove the 2 bolts and rear seat cushion support bracket.
5. **REMOVE REAR FLOOR SERVICE HOLE COVER**  
(a) Remove the rear floor service hole cover.
6. **DISCONNECT FUEL PUMP CONNECTOR**

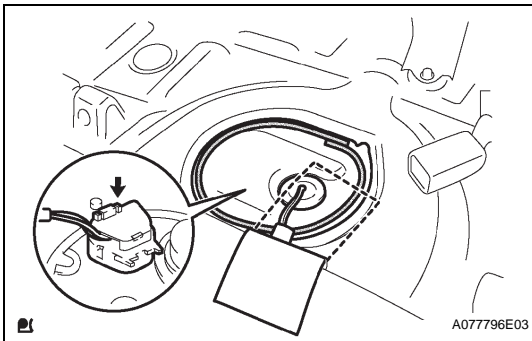

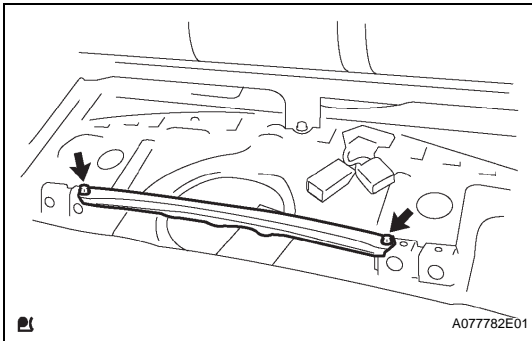
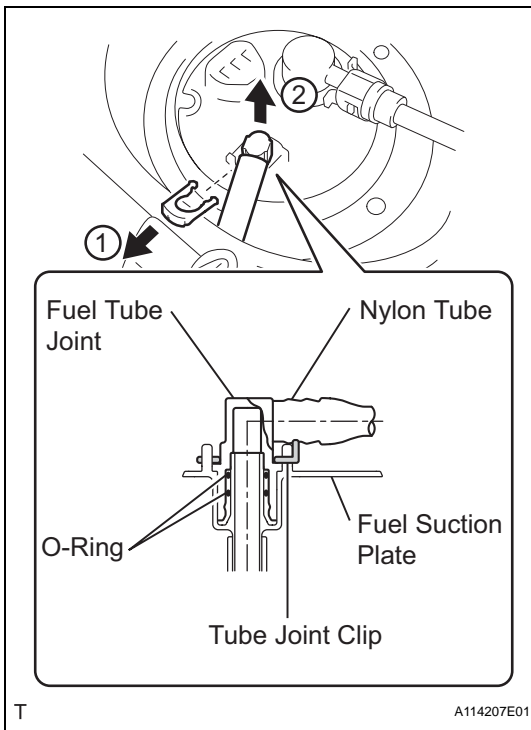

## 7. DISCONNECT FUEL PUMP TUBE SUB-ASSEMBLY

- (a) Remove the tube joint clip, and pull out the fuel pump tube.

### NOTICE:

- Check around the connector for dirt or mud before this operation and clean as necessary.
- Be careful of mud because the quick connector has an O-ring (which seals the pipe and connector) that can be contaminated.
- Do not use any tool in this operation.
- Do not bend or twist the nylon tube. Protect the connector by covering it with a plastic bag.
- When the pipe and connector are stuck, push and pull the connector to release and disconnect the connector.

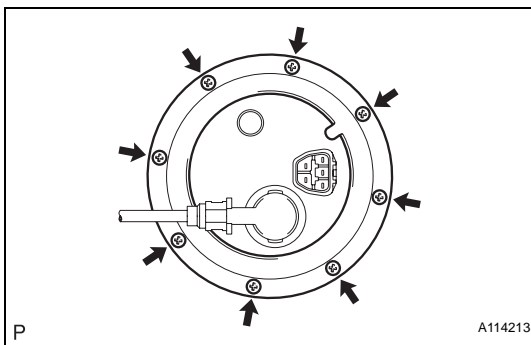

## 8. REMOVE FUEL TANK VENT TUBE SET PLATE BOLT

- (a) Remove the 8 bolts.

### HINT:

Only remove the bolts. The fuel tank vent tube set plate is removed in the next step.

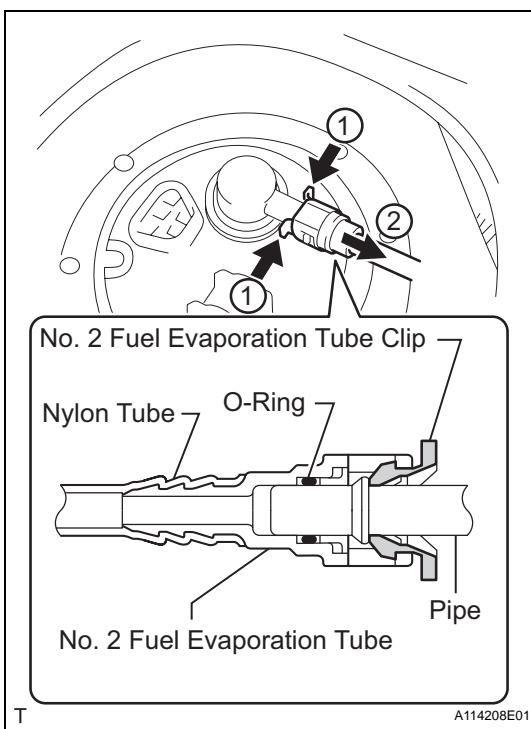

## 9. DISCONNECT NO. 2 FUEL EVAPORATION TUBE SUB-ASSEMBLY

- (a) Pinch the No. 2 fuel evaporation tube clip and then pull out the No. 2 fuel evaporation tube.

### NOTICE:

- Check around the connector for dirt or mud before this operation and clean as necessary.
- Be careful of mud because the quick connector has an O-ring (which seals the pipe and connector) that can be contaminated.
- Do not use any tool in this operation.
- Do not bend or twist the nylon tube. Protect the connector by covering it with a plastic bag.
- When the pipe and connector are stuck, push and pull the connector to release and disconnect the connector.

- (b) Remove the fuel tank vent tube set plate.

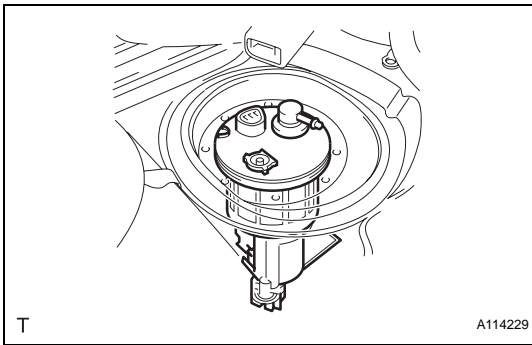

### 10. REMOVE FUEL PUMP ASSEMBLY WITH FUEL SENDER GAUGE ASSEMBLY

- (a) Remove the fuel pump with fuel sender gauge from the fuel tank.

**CAUTION:**

- Do not damage the fuel pump filter.
- Do not bend the arm of the fuel sender gauge.

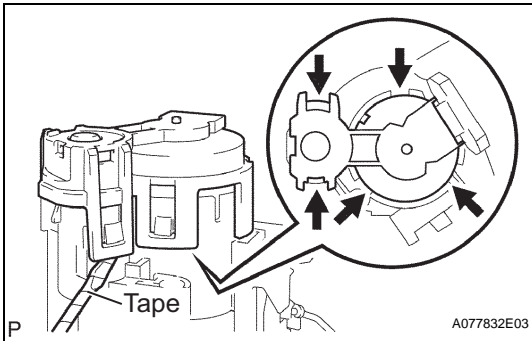

### 11. REMOVE NO. 2 FUEL SUCTION SUPPORT

- (a) Using a screwdriver with its tip wrapped in tape, detach the 5 snap claws from the claw holes, and remove the fuel suction support.

**NOTICE:**

Do not damage the fuel suction support.

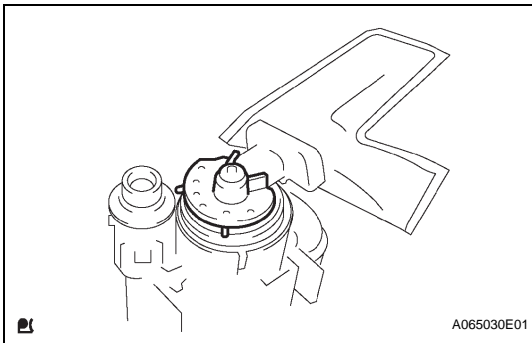

### 12. REMOVE FUEL PUMP CUSHION RUBBER

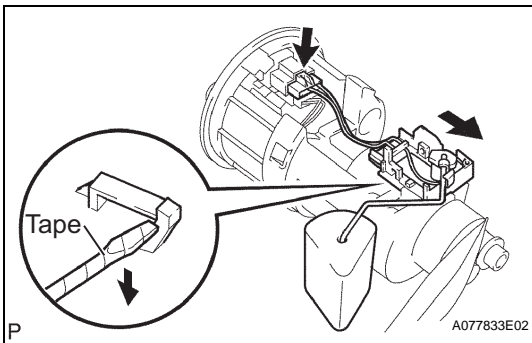

### 13. REMOVE FUEL SENDER GAUGE ASSEMBLY

- (a) Disconnect the fuel sender gauge connector.
- (b) Using a screwdriver with its tip wrapped in tape, unfasten the clamp to release the fuel sender gauge. Slide the fuel sender gauge to remove it from the fuel pump.

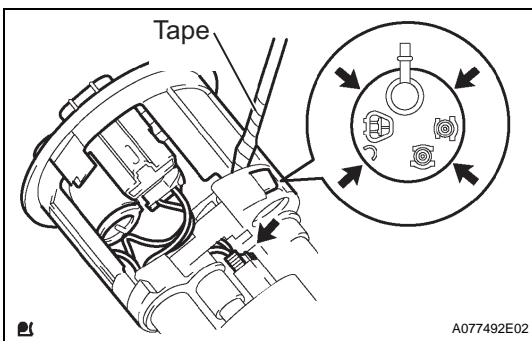

### 14. REMOVE FUEL SUCTION PLATE SUB-ASSEMBLY

- (a) Disconnect the fuel pump connector.
- (b) Using a screwdriver with its tip wrapped in tape, detach the 4 snap claws from the claw holes, and pull out the fuel suction plate.

**NOTICE:**

Do not damage the fuel pump filter.

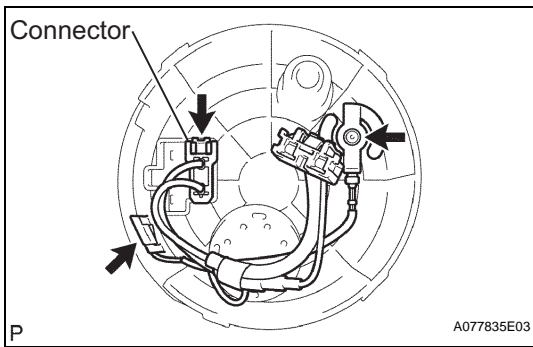
**15. REMOVE FUEL PUMP HARNESS**

- (a) Disconnect the connector.
- (b) Using a small screwdriver, pry out the fuel pump harness.

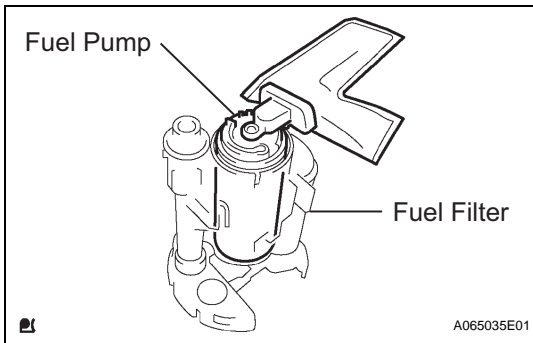
**16. REMOVE FUEL PUMP**

- (a) Pull out the fuel pump from the fuel filter.

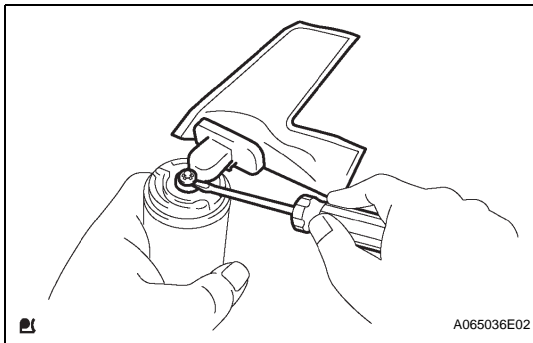
**17. REMOVE FUEL PUMP FILTER**

- (a) Using a small screwdriver, pry out the clip.
- (b) Pull out the fuel pump filter from the fuel pump.

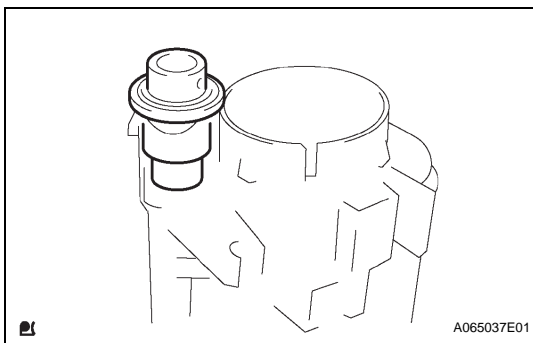
**18. REMOVE FUEL PRESSURE REGULATOR ASSEMBLY**

- (a) Pull out the fuel pressure regulator from the fuel filter.
- (b) Remove the O-ring from the fuel pressure regulator.

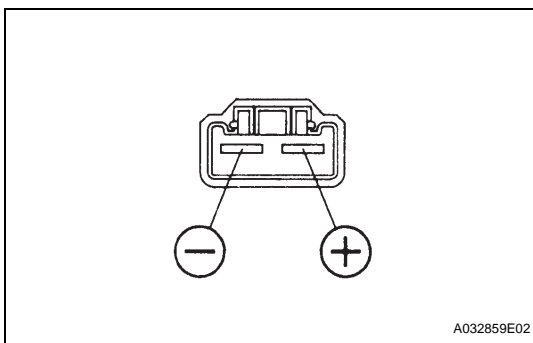
**INSPECTION****1. INSPECT FUEL PUMP**

- (a) Inspect the fuel pump resistance.
  - (1) Measure the resistance between the terminals.

**Standard resistance:**

**0.2 to 3.0  $\Omega$  at 20°C (68°F)**