

## INSPECTION

### 1. INSPECT FUEL INJECTOR ASSEMBLY

- (a) Inspect the resistance.  
 (1) Measure the resistance between the terminals.

**Standard resistance:**

**13.5 to 14.2  $\Omega$  at 21°C (70°F)**

If the result is not as specified, replace the injector assembly.

- (b) Inspect the injector operation.

**CAUTION:**

- **Perform the test in a well-ventilated area and be careful of flames.**
- **Carefully handle the fuel tube connector.**

- (1) Prepare a fuel tube connector.

HINT:

Part No. 23901-21060

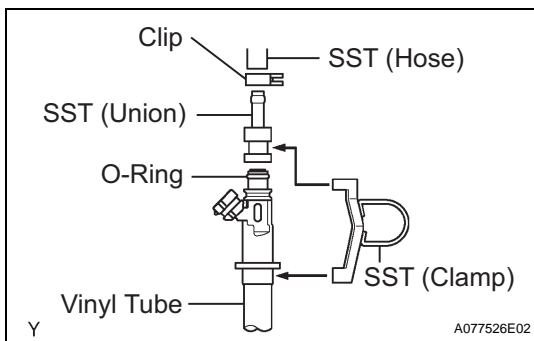
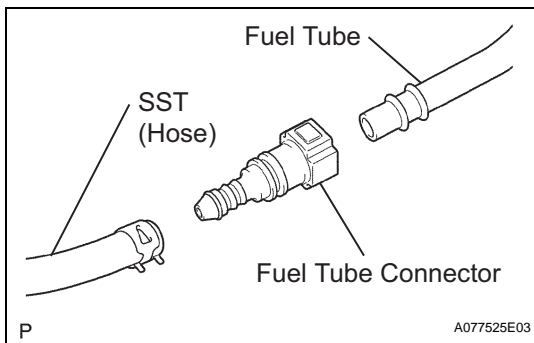
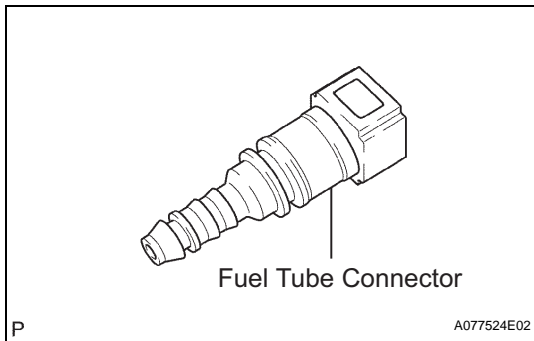

- (2) Connect SST and the fuel tube connector to the fuel pipe.

**SST 09268-41047 (95336-08070)**

**CAUTION:**

**After following the precautions of the FUEL SYSTEM, connect the fuel tube connector (quick type).**

- (3) Install a new O-ring to the injector.  
 (4) Connect SST (union and hose) to the injector, and hold the injector and union with SST (clamp).

**SST 09268-41047 (95336-08070, 09268-41110, 09268-41300), 09842-30080**

- (5) Put the injector into a graduated cylinder.

HINT:

Install a suitable vinyl tube onto the injector to prevent fuel spray.

- (6) Operate the fuel pump (see page [FU-8](#)).

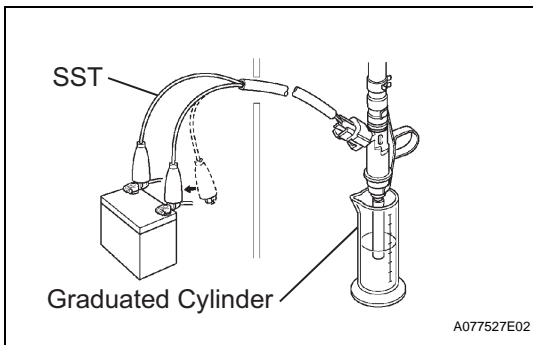

- (7) Connect SST (wire) to the injector and battery for 15 seconds, and measure the injection volume with the graduated cylinder. Test each injector 2 or 3 times.

**SST 09842-30080**

**Standard injection volume**

Injection Volume	Difference between each injector
47 to 58 cm <sup>3</sup> (2.9 to 3.5 cu in.) per 15 seconds	11 cm <sup>3</sup> (0.6 cu in.) or less

**NOTICE:**

**Always do the switching at the battery side.**

If the injection volume is not as specified, replace the injector assembly.

- (c) Inspect the leakage.
- (1) In the condition above, disconnect the test probes of SST (wire) from the battery and check the fuel leakage from the injector.

**Standard fuel drop:**

**1 drop or less in 12 minutes**

If the injection volume is not as specified, replace the injector assembly.

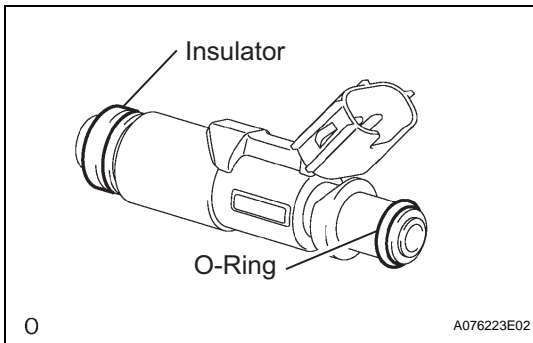

## INSTALLATION

### 1. INSTALL FUEL INJECTOR ASSEMBLY

- (a) Install new insulators onto each fuel injector.
- (b) Apply a light coat of grease or gasoline to new O-rings and install them onto each fuel injector.
- (c) Apply a light coat of grease or gasoline to the place where each fuel delivery pipe comes into contact with each O-ring.

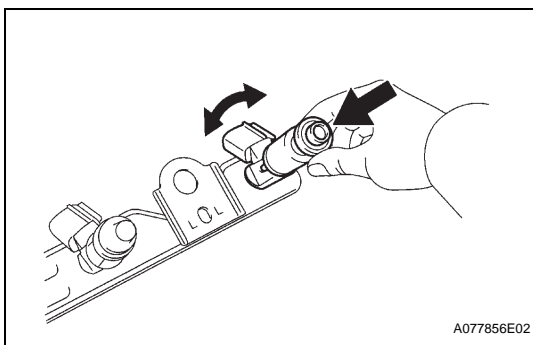

- (d) While turning each fuel injector clockwise and counterclockwise, push it into each fuel delivery pipe.

**NOTICE:**

- **Be careful not to twist the O-ring.**
- **After installing the fuel injectors, check that they turn smoothly. If they do not, replace the O-ring of the improperly installed fuel injector with a new one, and install the fuel injector again.**

### 2. INSTALL FUEL DELIVERY PIPE SUB-ASSEMBLY

- (a) Install the 2 spacers onto the cylinder head.

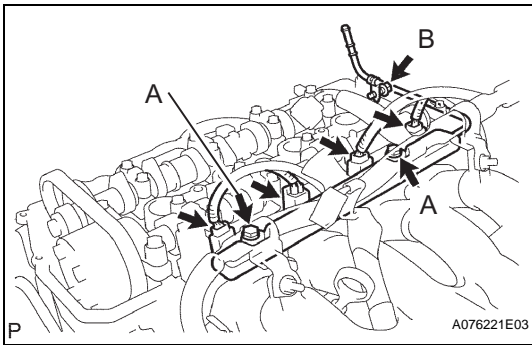

- (b) Install the fuel delivery pipe with the 4 fuel injectors.  
**Torque: 19 N\*m (194 kgf\*cm, 14 ft.\*lbf) for bolt A**  
**9.0 N\*m (92 kgf\*cm, 80 in.\*lbf) for bolt B**

**NOTICE:**

- Be careful not to drop the fuel injectors when installing the fuel delivery pipe.
- Check that the fuel injectors rotate smoothly after installing the fuel delivery pipe.

- (c) Connect the 4 fuel injector connectors.

**3. CONNECT FUEL TUBE SUB-ASSEMBLY**

- (a) Connect the fuel tube.

- (1) Check the connected part of the pipe for damage or foreign objects.
- (2) Align the axis of the connector with the axis of the pipe, and push the pipe into the connector until the connector makes a "click" sound. If the connection is tight, apply a small amount of fresh engine oil to the tip of the pipe.

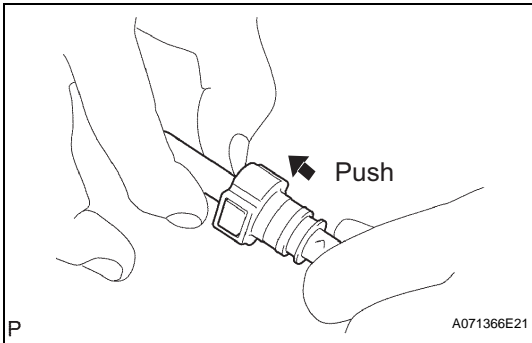

- (3) After finishing the connection, check that the pipe and connector are securely connected by pulling them.

- (b) Install the fuel pipe clamp.

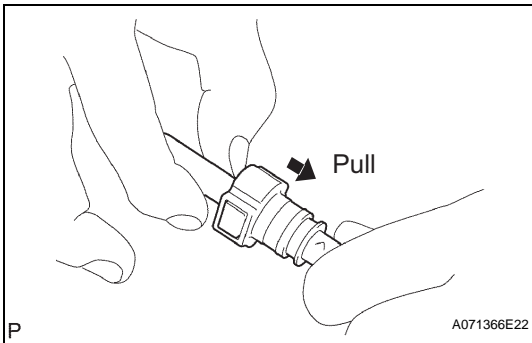
**4. INSTALL CYLINDER HEAD COVER SUB-ASSEMBLY (See page EM-21)****5. INSTALL IGNITION COIL (See page IG-8)****6. CONNECT CABLE TO NEGATIVE BATTERY TERMINAL****7. CHECK FOR FUEL LEAKS (See page FU-8)****8. INSTALL NO. 2 CYLINDER HEAD COVER**

- (a) Install the cylinder head cover.
- (b) First tighten the nuts labeled A, and then tighten the nuts labeled B.

**Torque: 7.0 N\*m (71 kgf\*cm, 62 in.\*lbf)**

