

ENGINE ASSEMBLY

COMPONENTS

EM

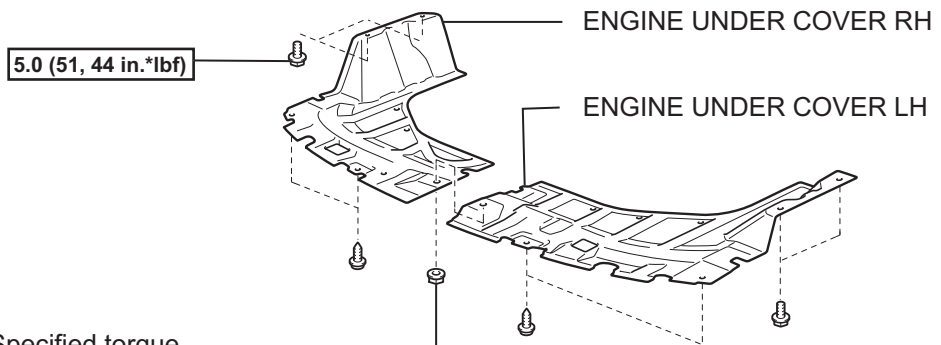
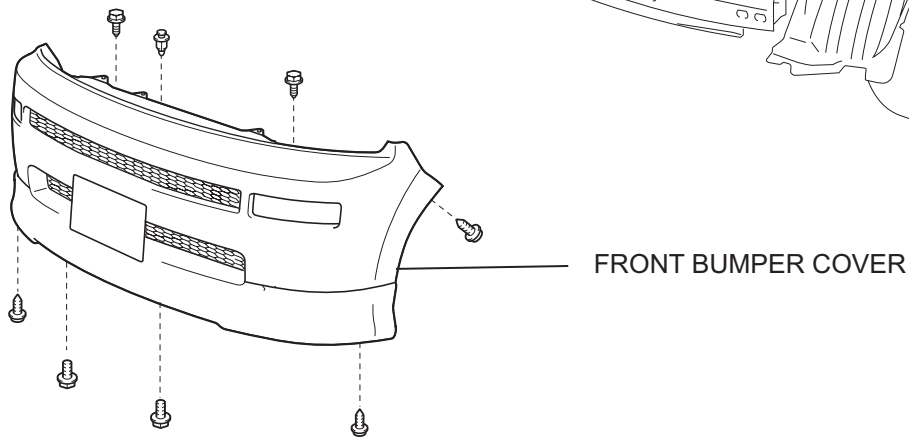
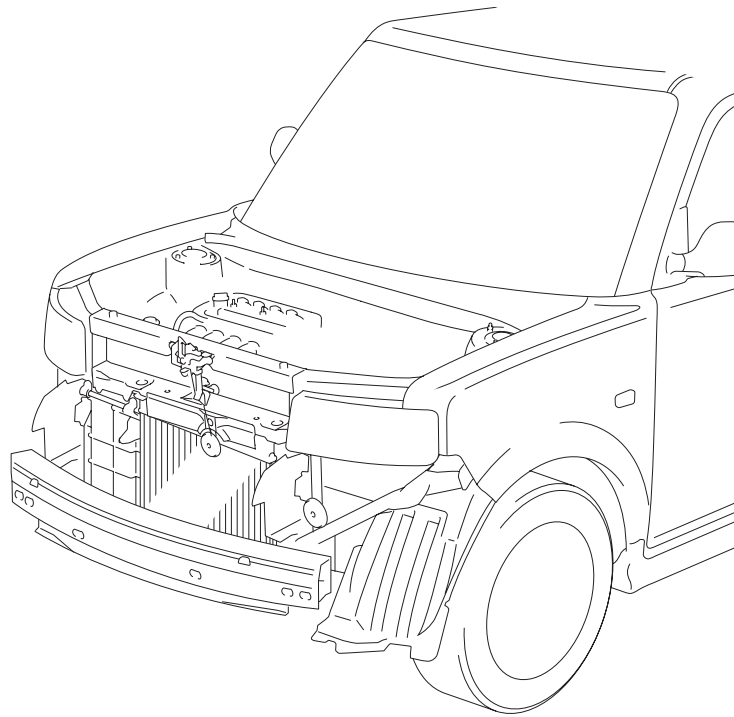
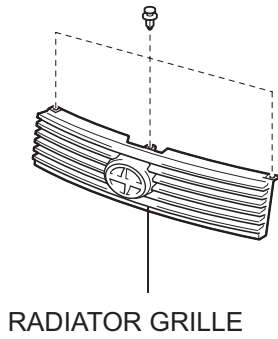

N*m (kgf*cm, ft.*lbf) : Specified torque

5.0 (51, 44 in.*lbf)

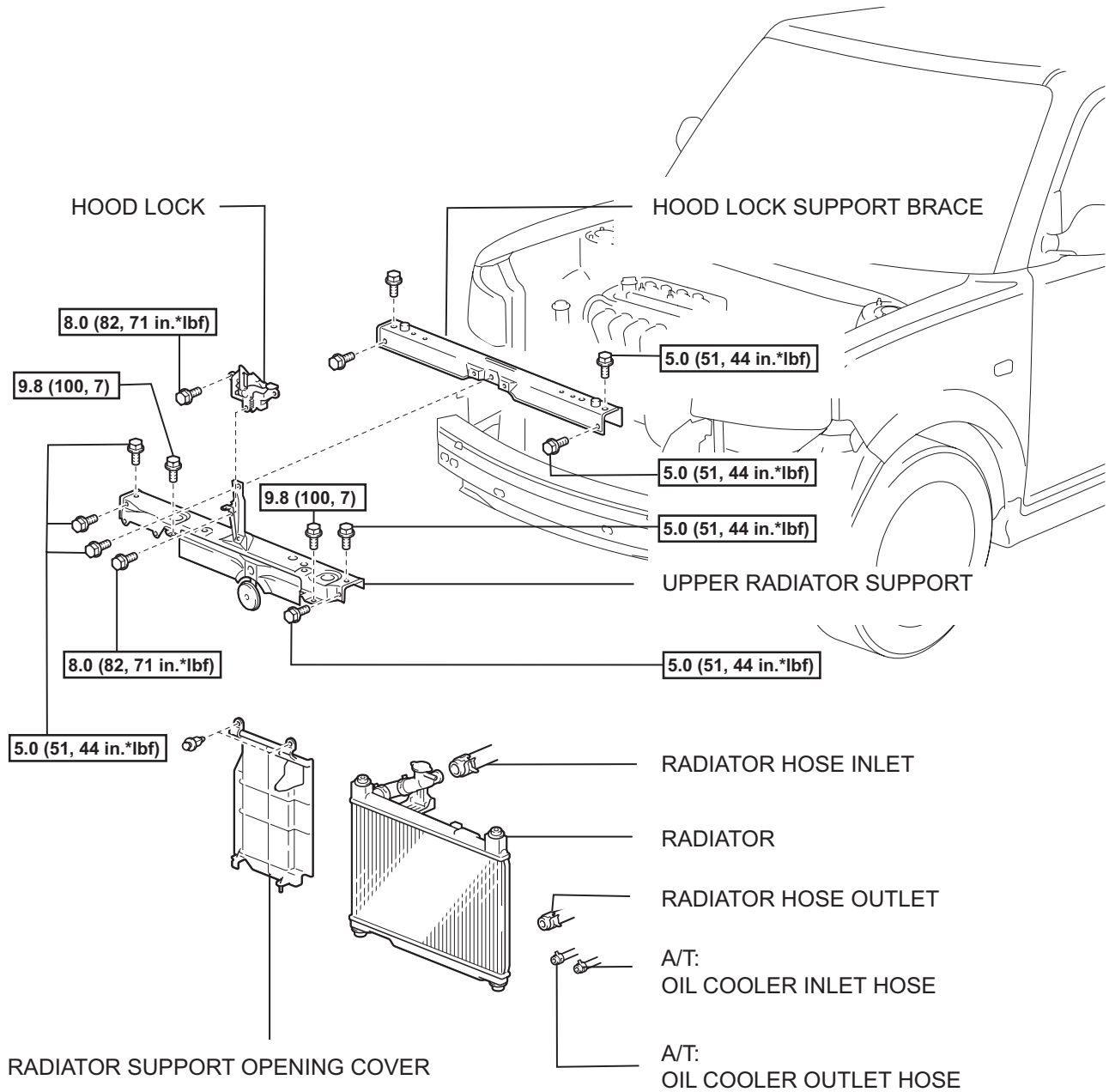

N*m (kgf*cm, ft.*lbf) : Specified torque

7.0 (71, 62 in.*lbf)

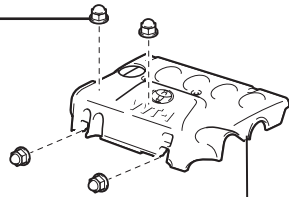

NO. 2 CYLINDER HEAD COVER

UNION TO CHECK VALVE HOSE

HEATER WATER OUTLET HOSE

HEATER WATER INLET HOSE

FUEL TUBE

ACCELERATOR CONTROL CABLE

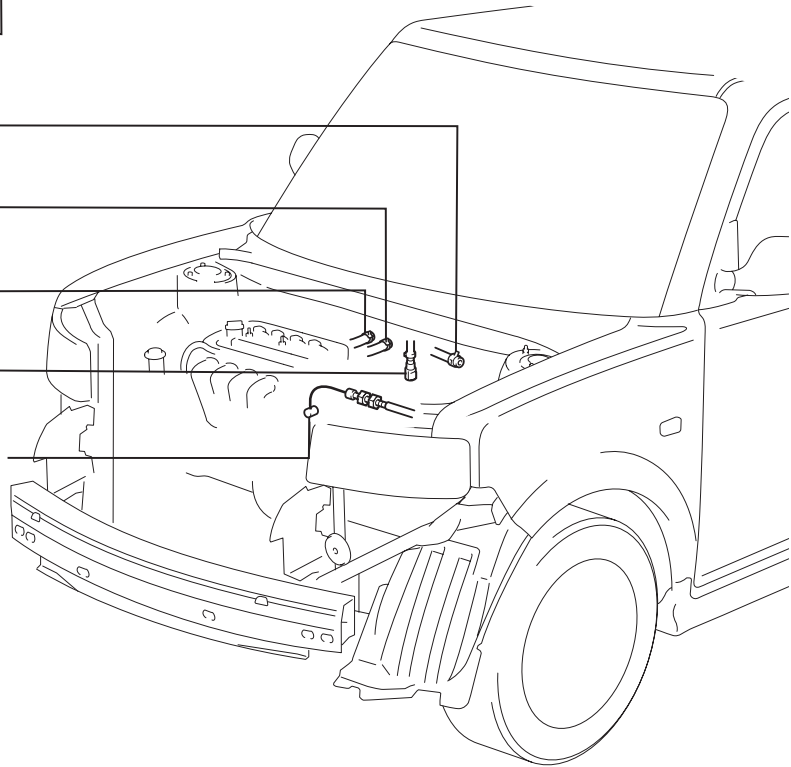

EM

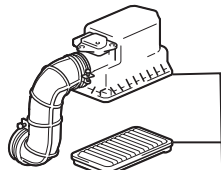

AIR CLEANER

7.8 (80, 69 in.*lbf)

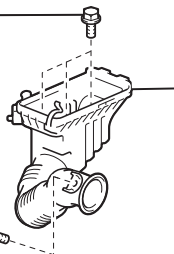

7.5 (76, 66 in.*lbf)

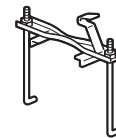

BATTERY CLAMP

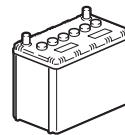

BATTERY

N*m (kgf*cm, ft.*lbf) : Specified torque

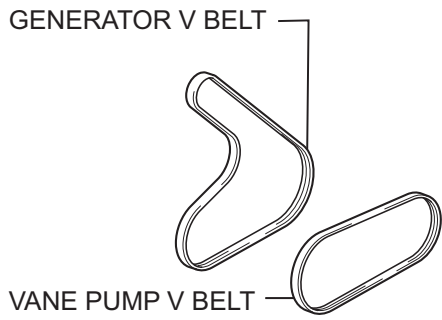

A/T

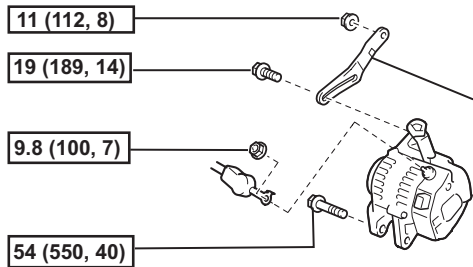
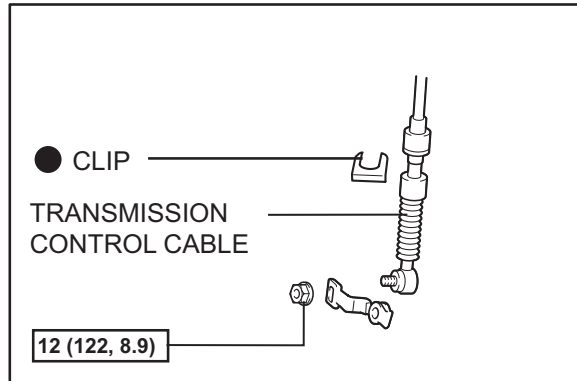

FAN BELT ADJUSTING BAR

GENERATOR

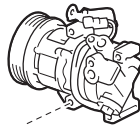

COOLER COMPRESSOR

25 (255, 18)

19 (189, 14)

12 (122, 9)

● CLIP

CLIP

CLUTCH RELEASE CYLINDER

TRANSMISSION CONTROL CABLE

N*m (kgf*cm, ft.*lbf) : Specified torque

● Non-reusable part

EM

EM

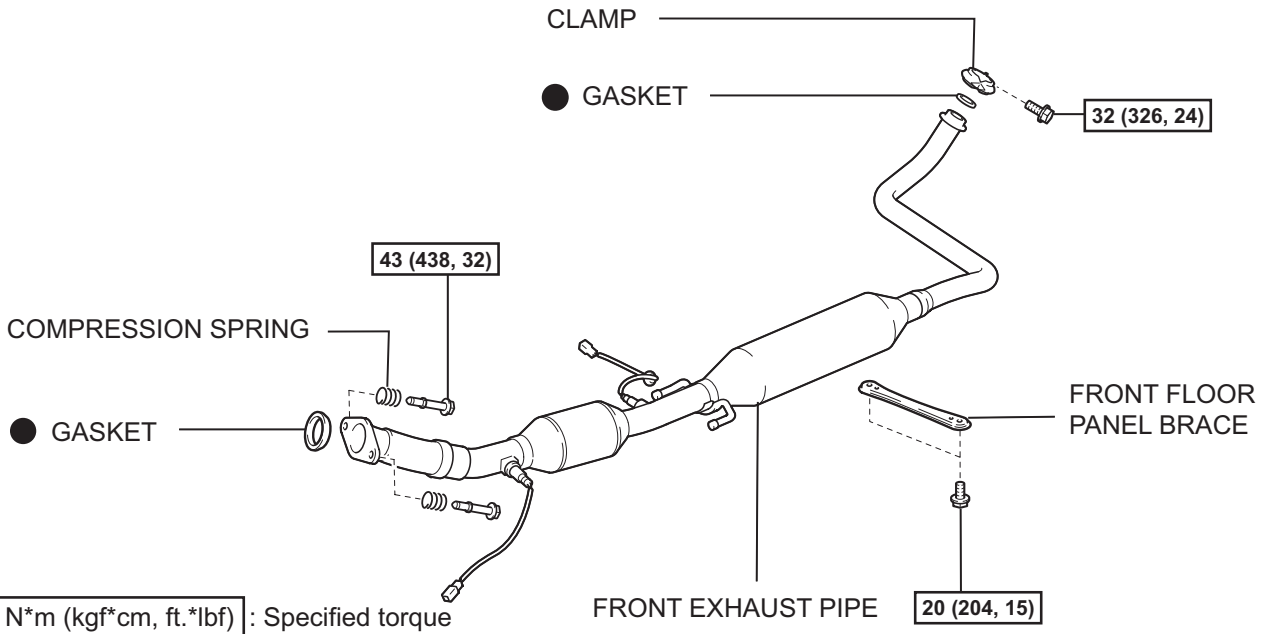
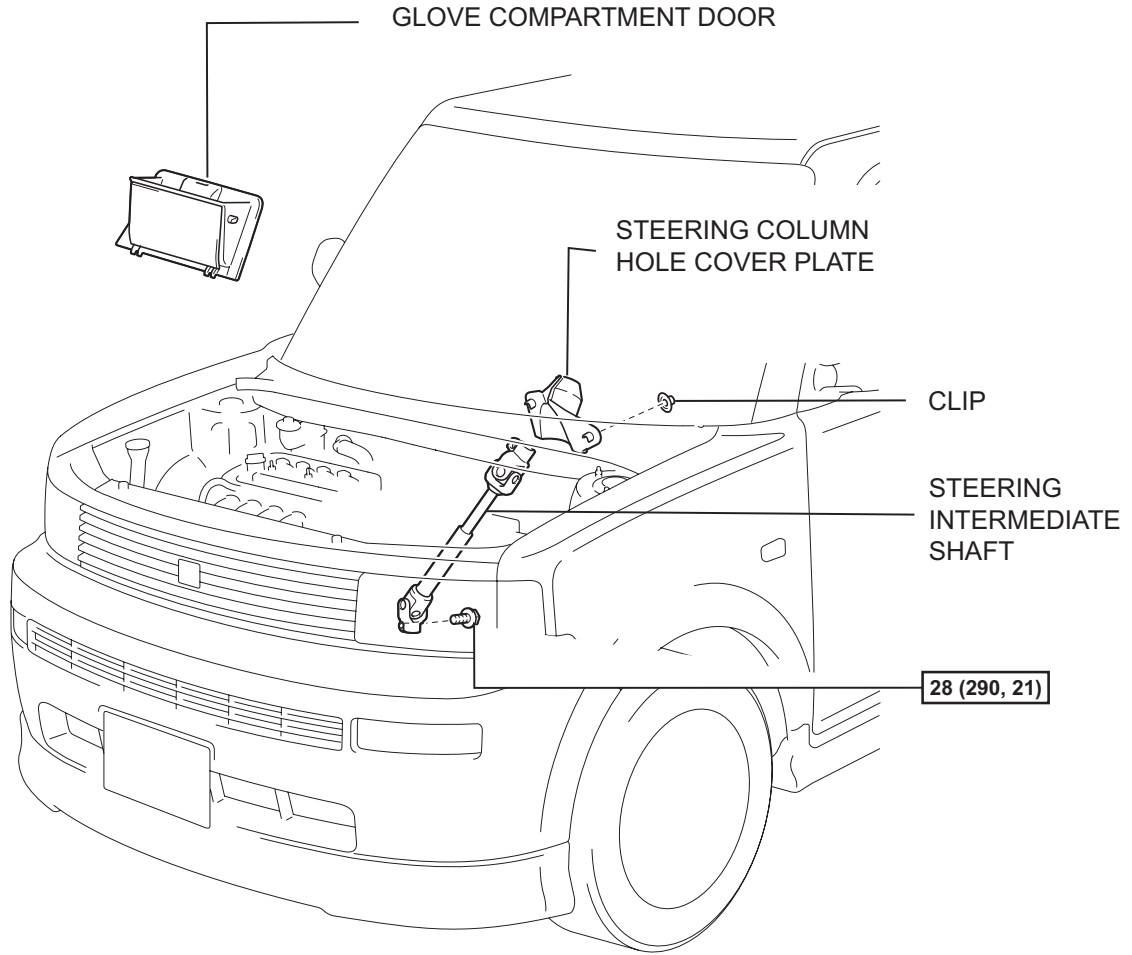

N*m (kgf*cm, ft.*lbf) : Specified torque

● Non-reusable part

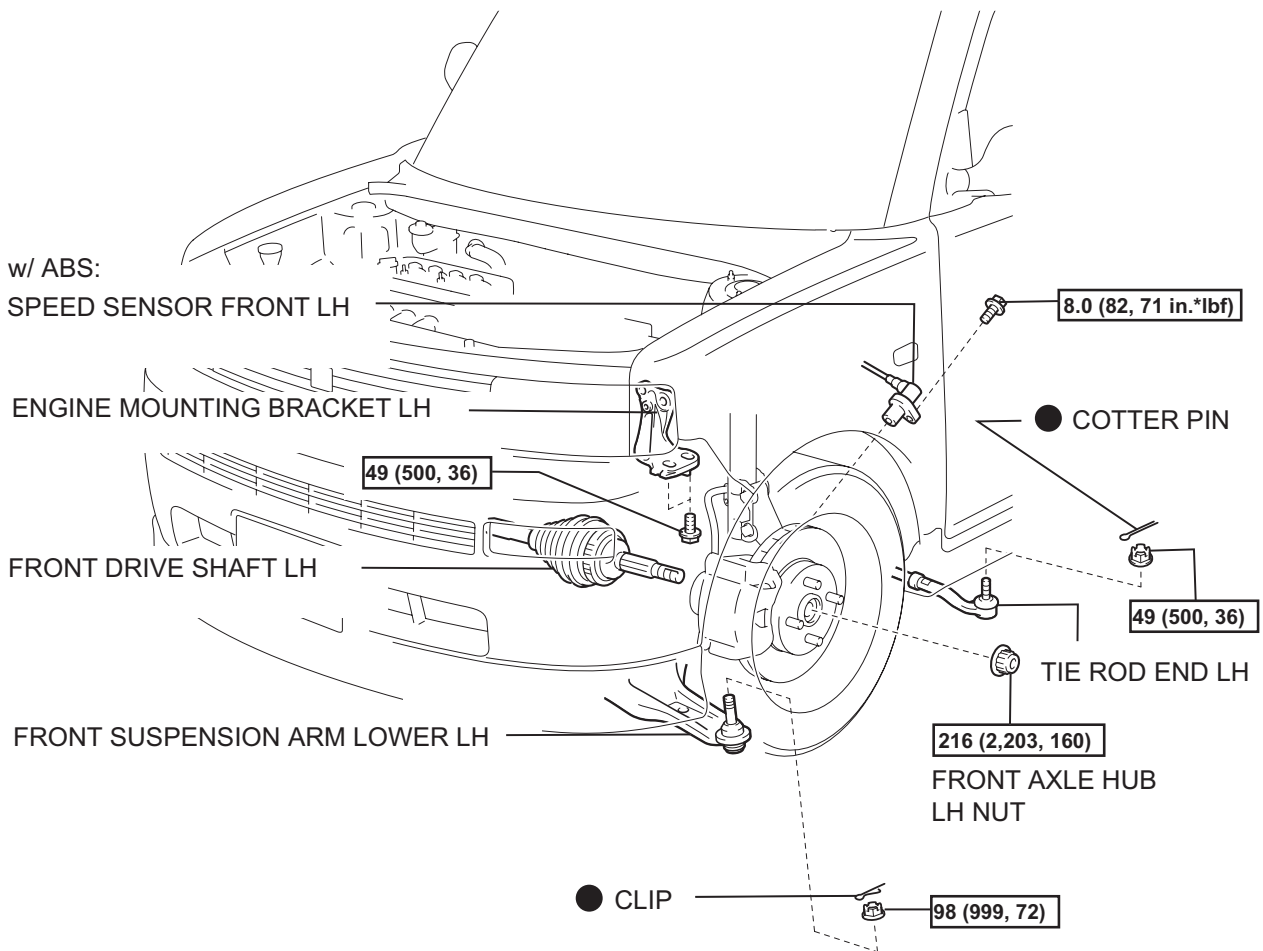
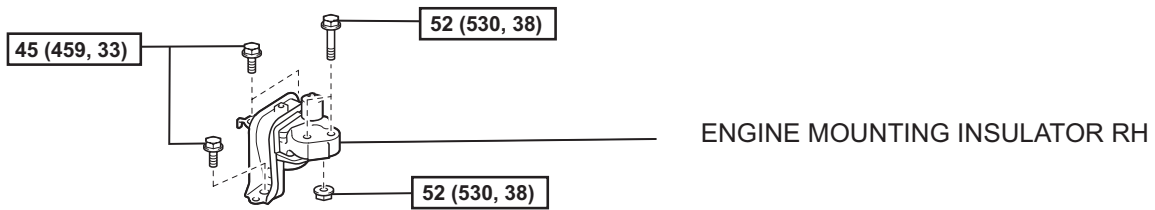
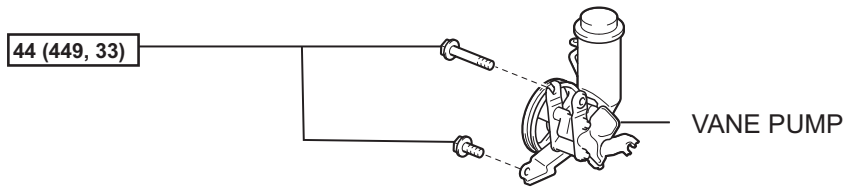

N*m (kgf*cm, ft.*lbf) : Specified torque

● Non-reusable part

EM

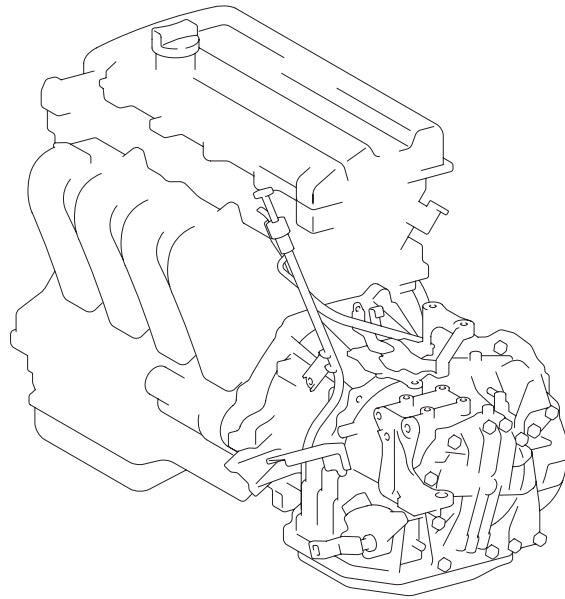

FRONT SUSPENSION MEMBER REINFORCEMENT RH

FRONT SUSPENSION MEMBER REINFORCEMENT LH

VANE PUMP

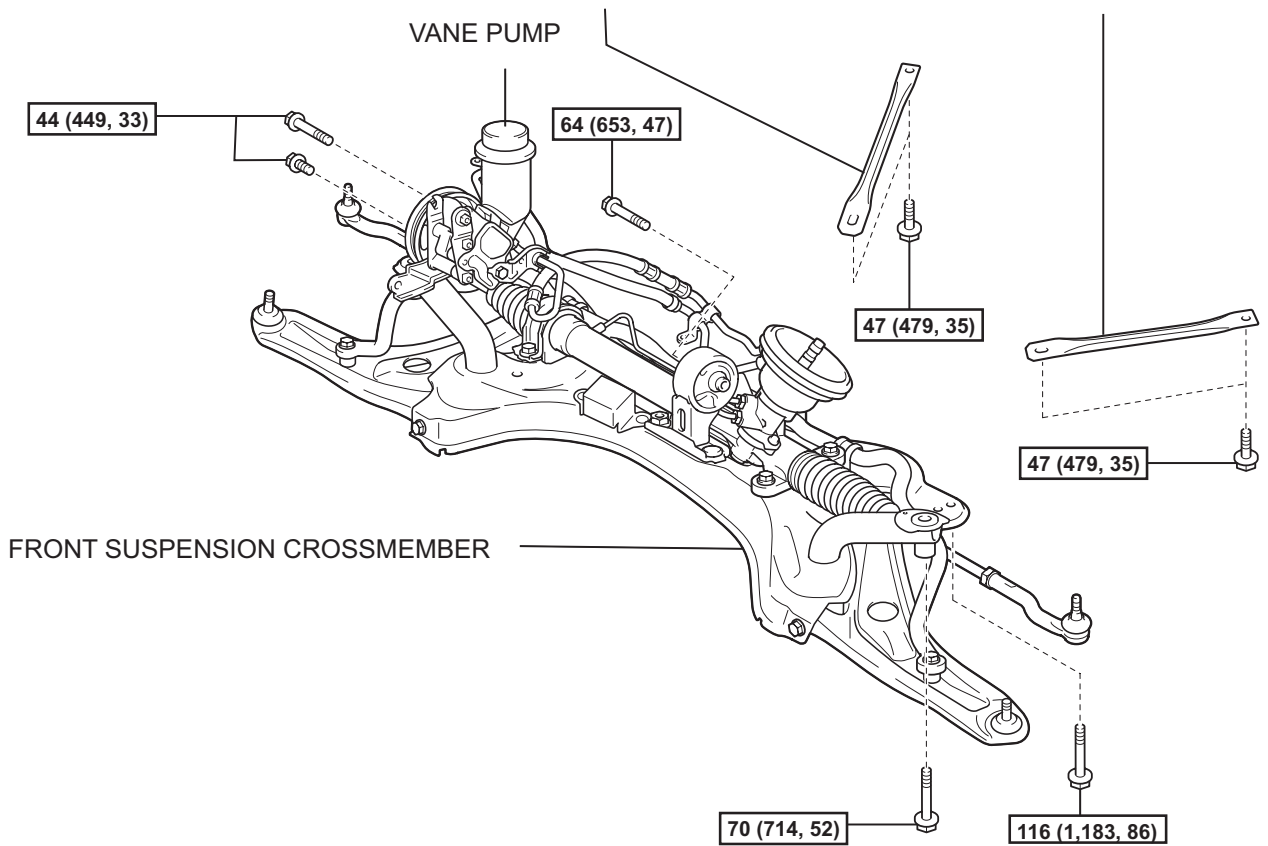

N*m (kgf*cm, ft.*lbf) : Specified torque

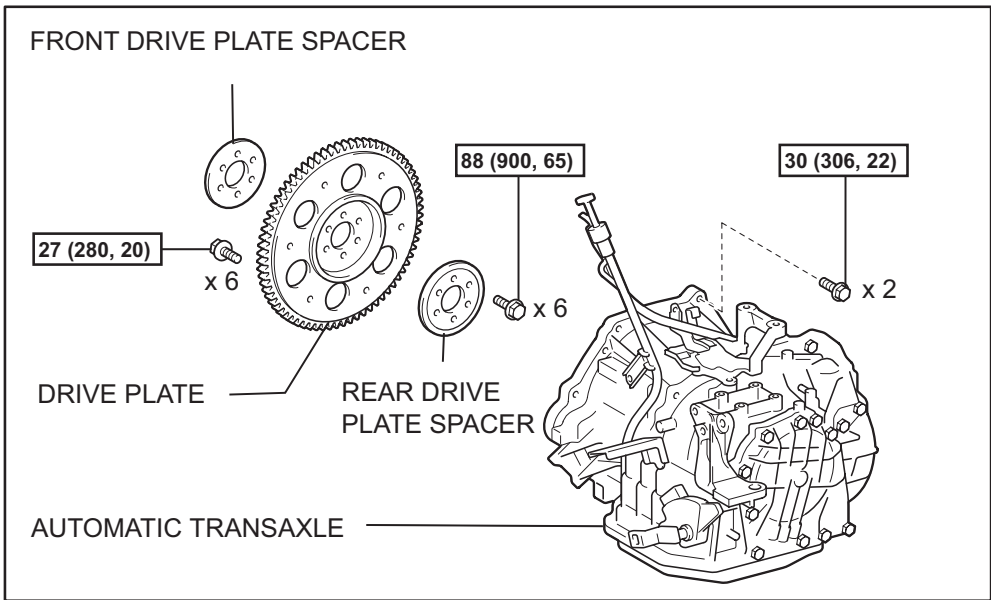
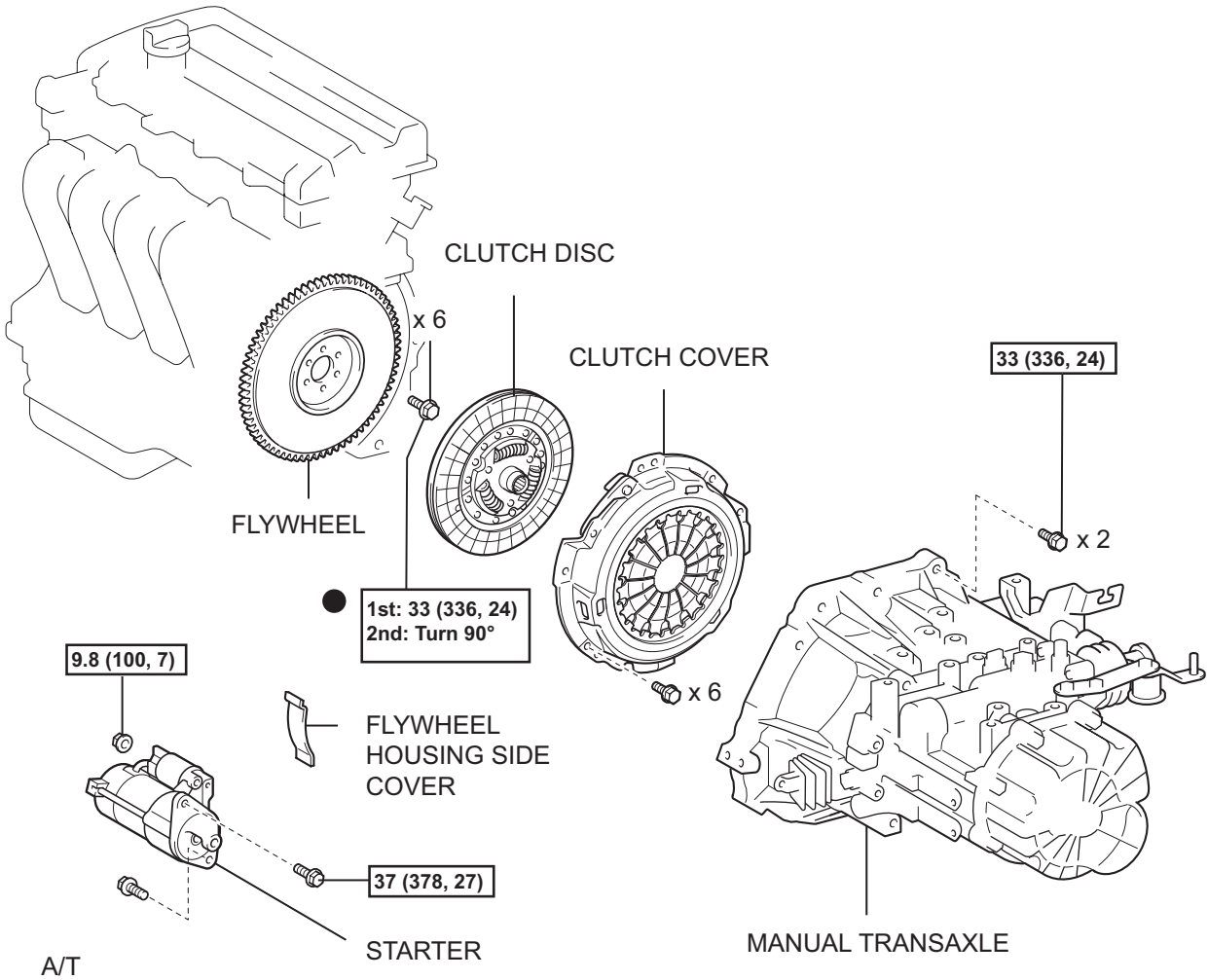

N*m (kgf*cm, ft.*lbf) : Specified torque

● Non-reusable part

EM

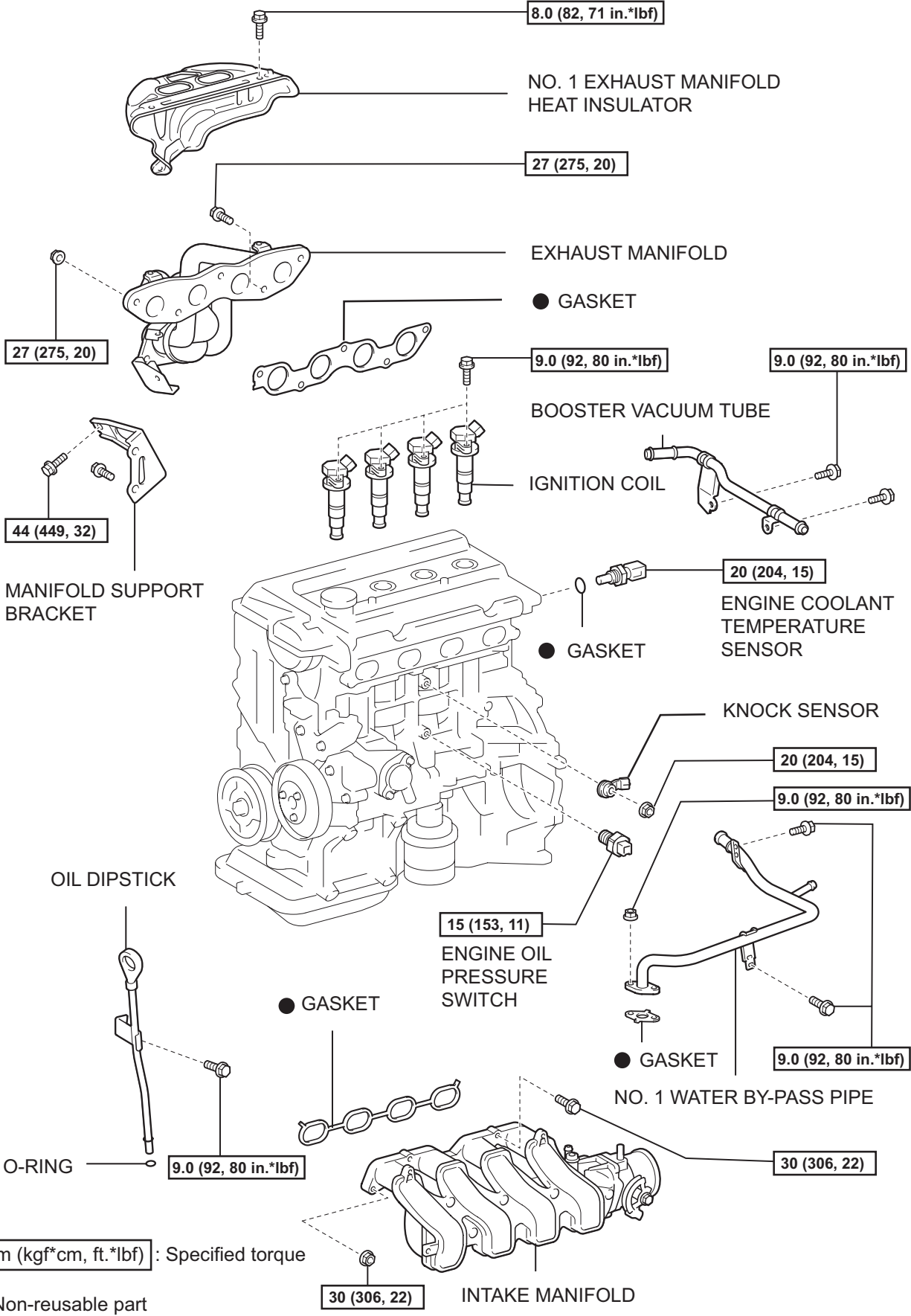

N*m (kgf*cm, ft.*lbf) : Specified torque

● Non-reusable part