

CYLINDER HEAD

COMPONENTS

7.0 (71, 62 in.*lbf)

NO. 2 CYLINDER HEAD COVER

7.0 (71, 62 in.*lbf)

5.0 (51, 44 in.*lbf)

ENGINE UNDER COVER RH

5.0 (51, 44 in.*lbf)

7.8 (80, 69 in.*lbf)

AIR CLEANER

7.5 (76, 66 in.*lbf)

N*m (kgf*cm, ft.*lbf) : Specified torque

EM

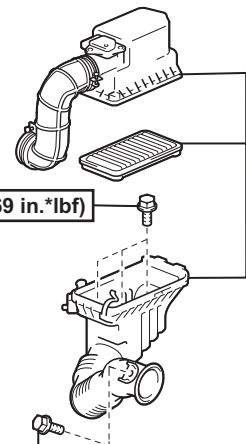
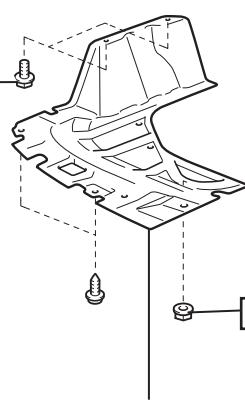
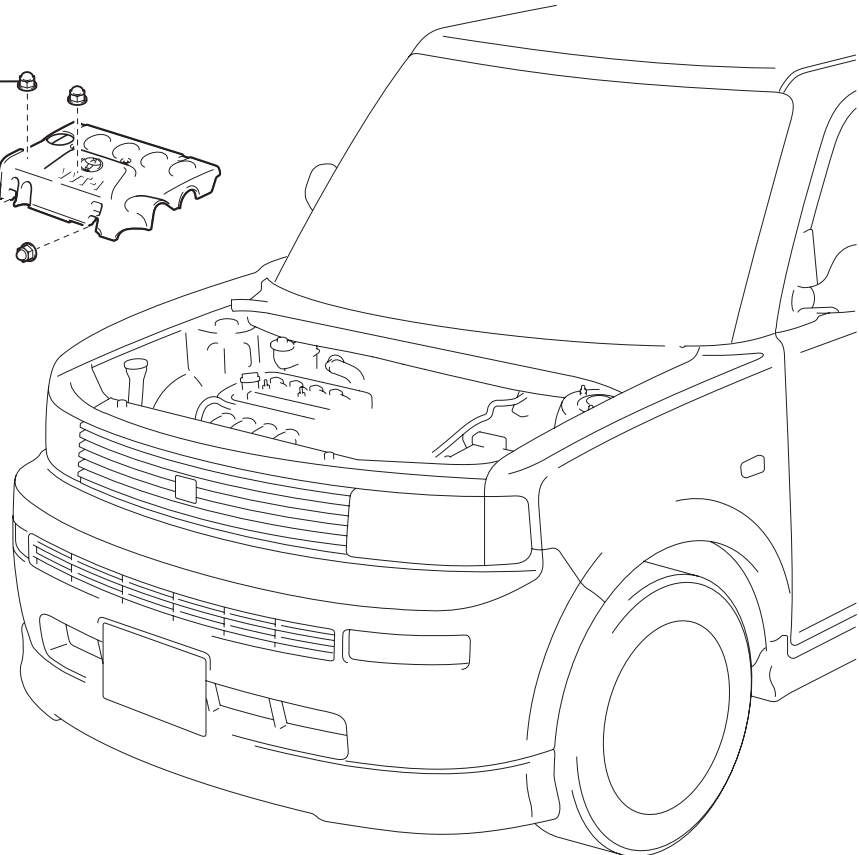

EM

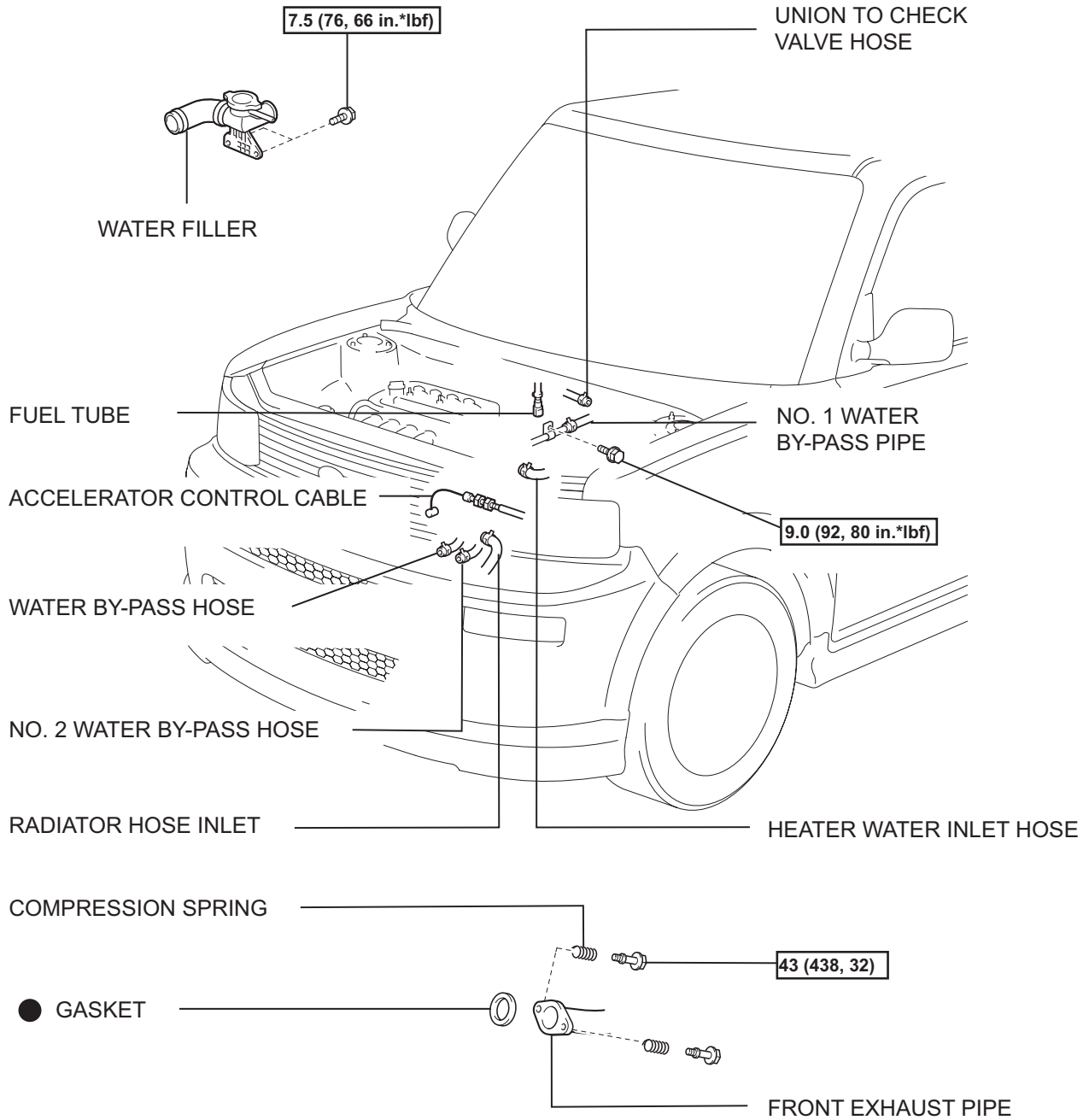

N*m (kgf*cm, ft.*lbf) : Specified torque

● Non-reusable part

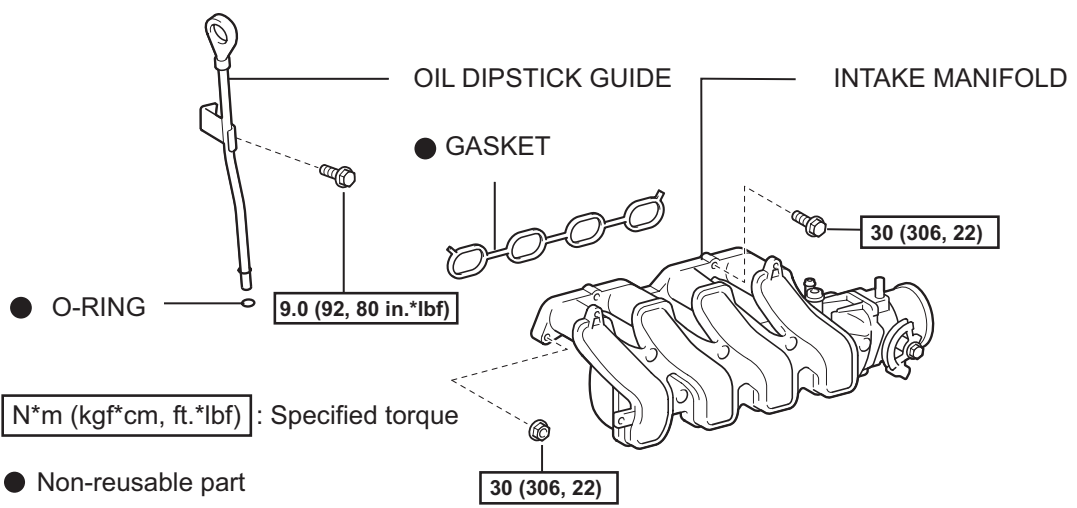
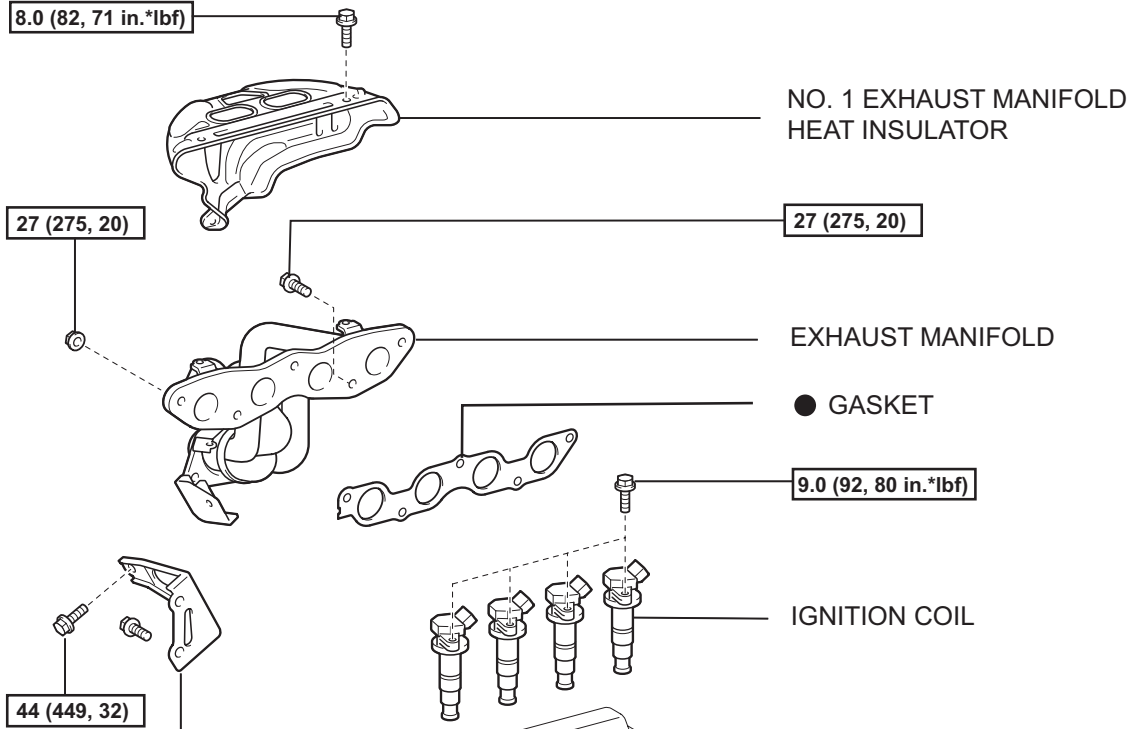

N*m (kgf*cm, ft.*lbf) : Specified torque

● Non-reusable part

EM

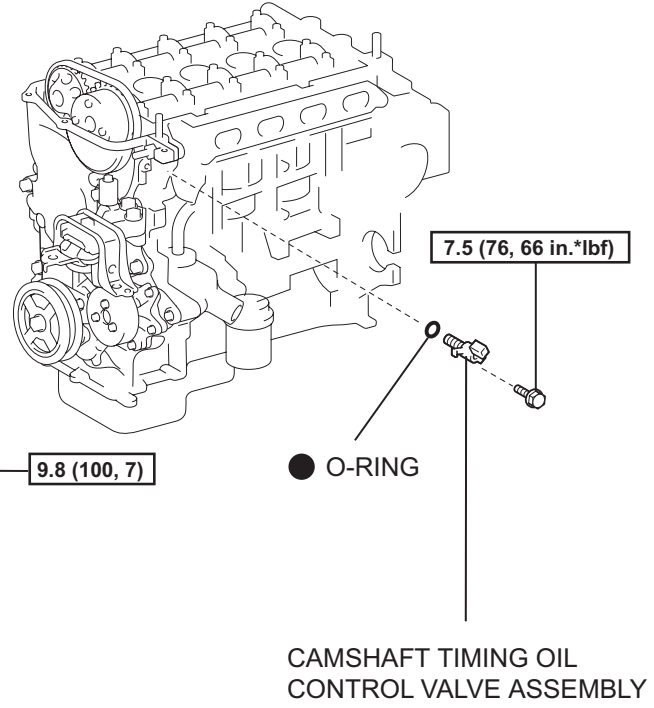
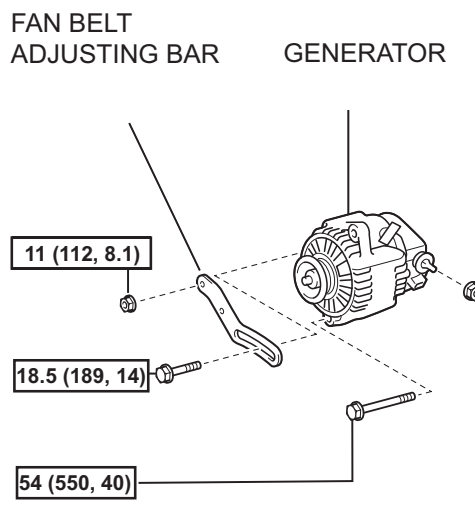
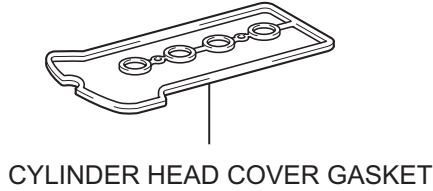
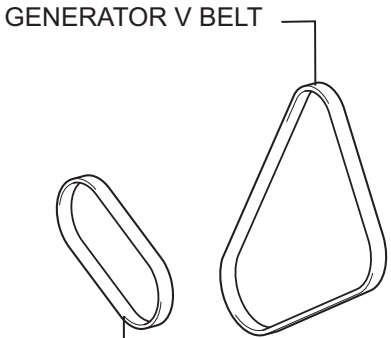
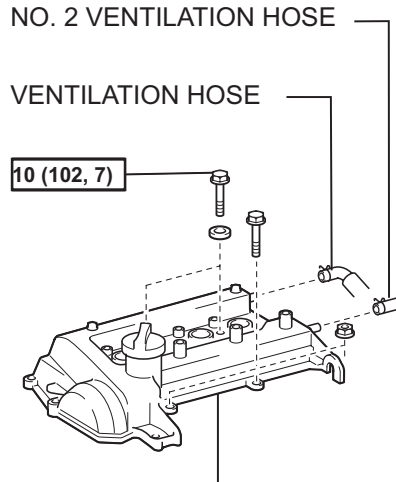

N*m (kgf*cm, ft.*lbf) : Specified torque

● Non-reusable part

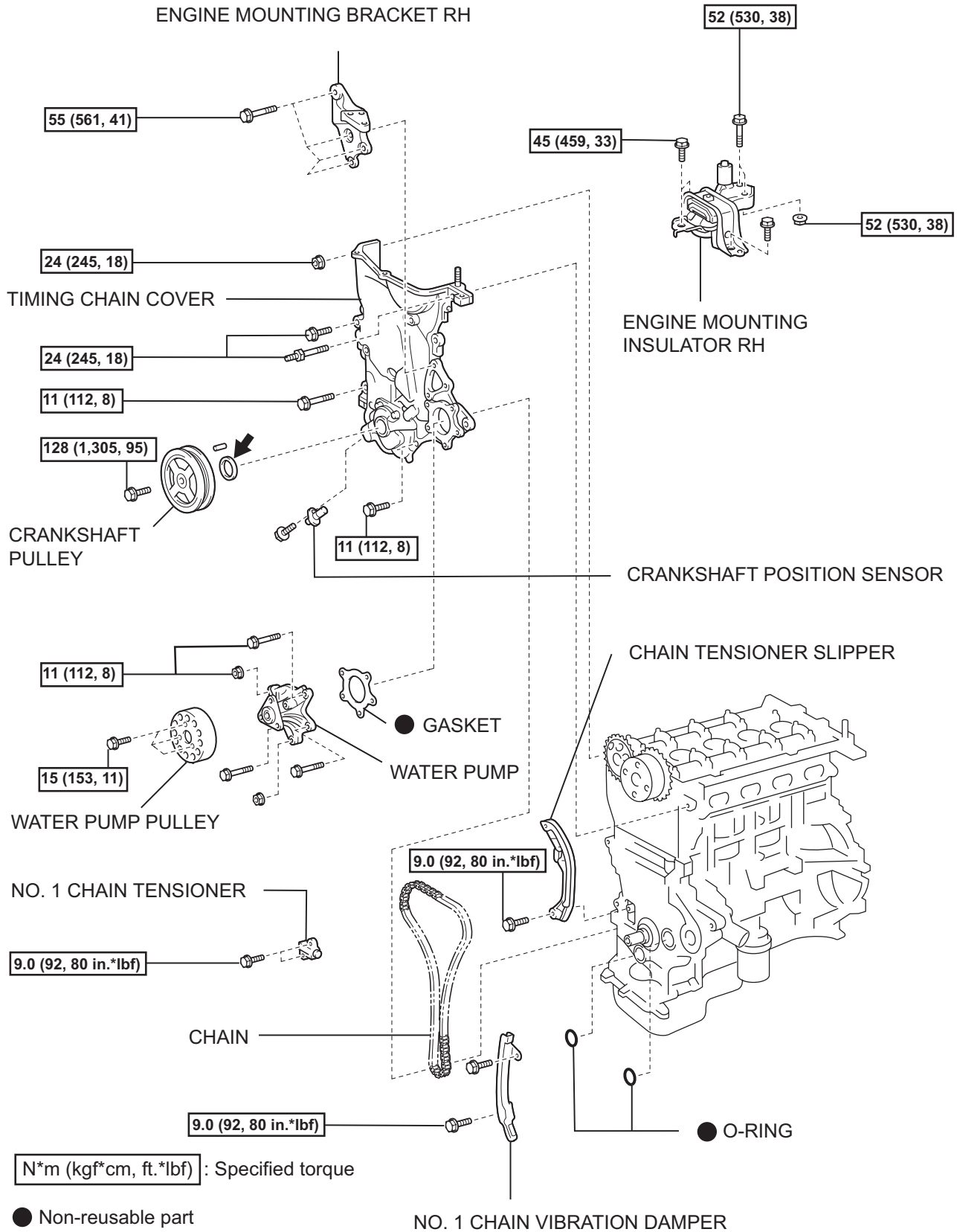

N*m (kgf*cm, ft.*lbf) : Specified torque

● Non-reusable part

← Apply MP grease

EM

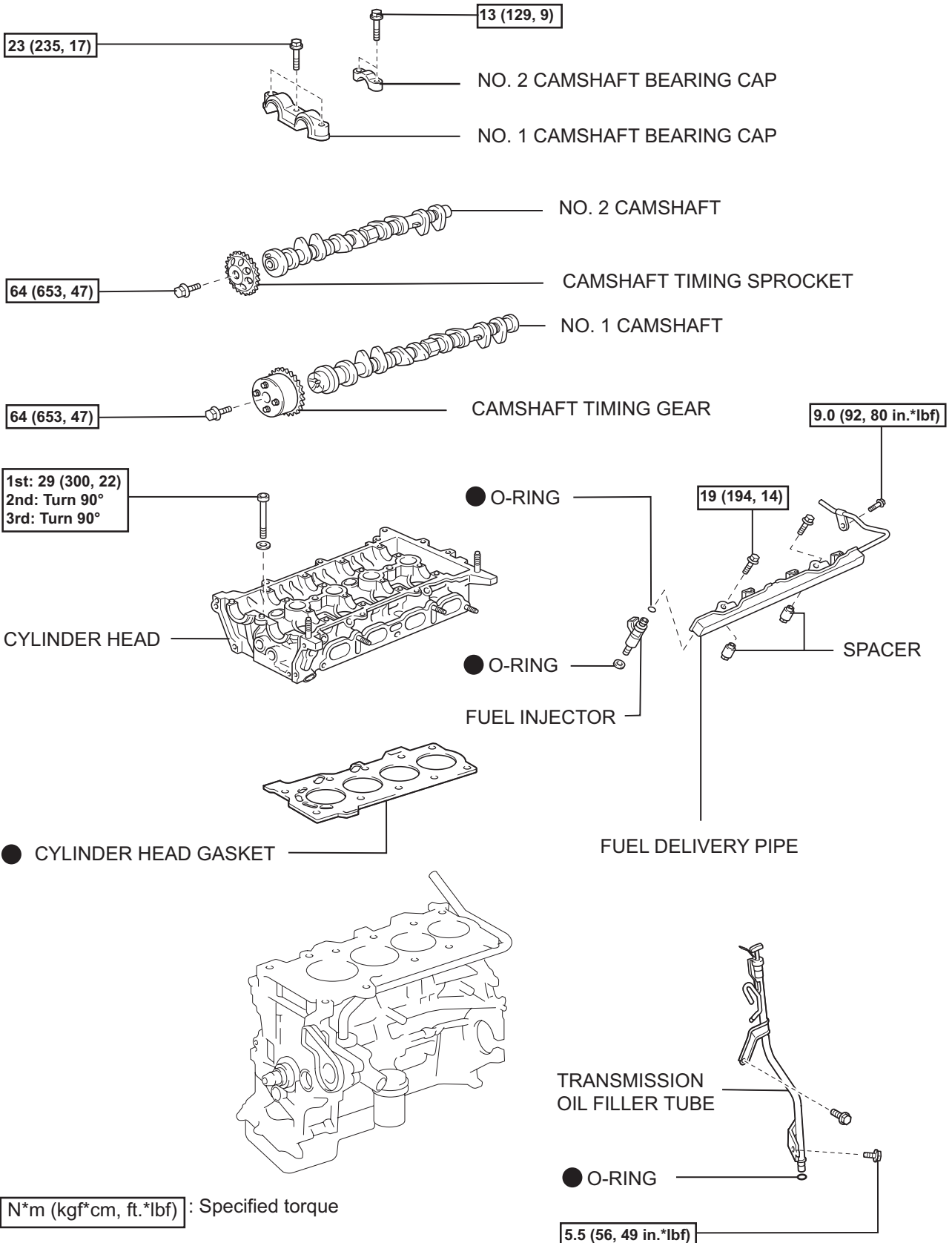

N*m (kgf*cm, ft.*lbf) : Specified torque

● Non-reusable part

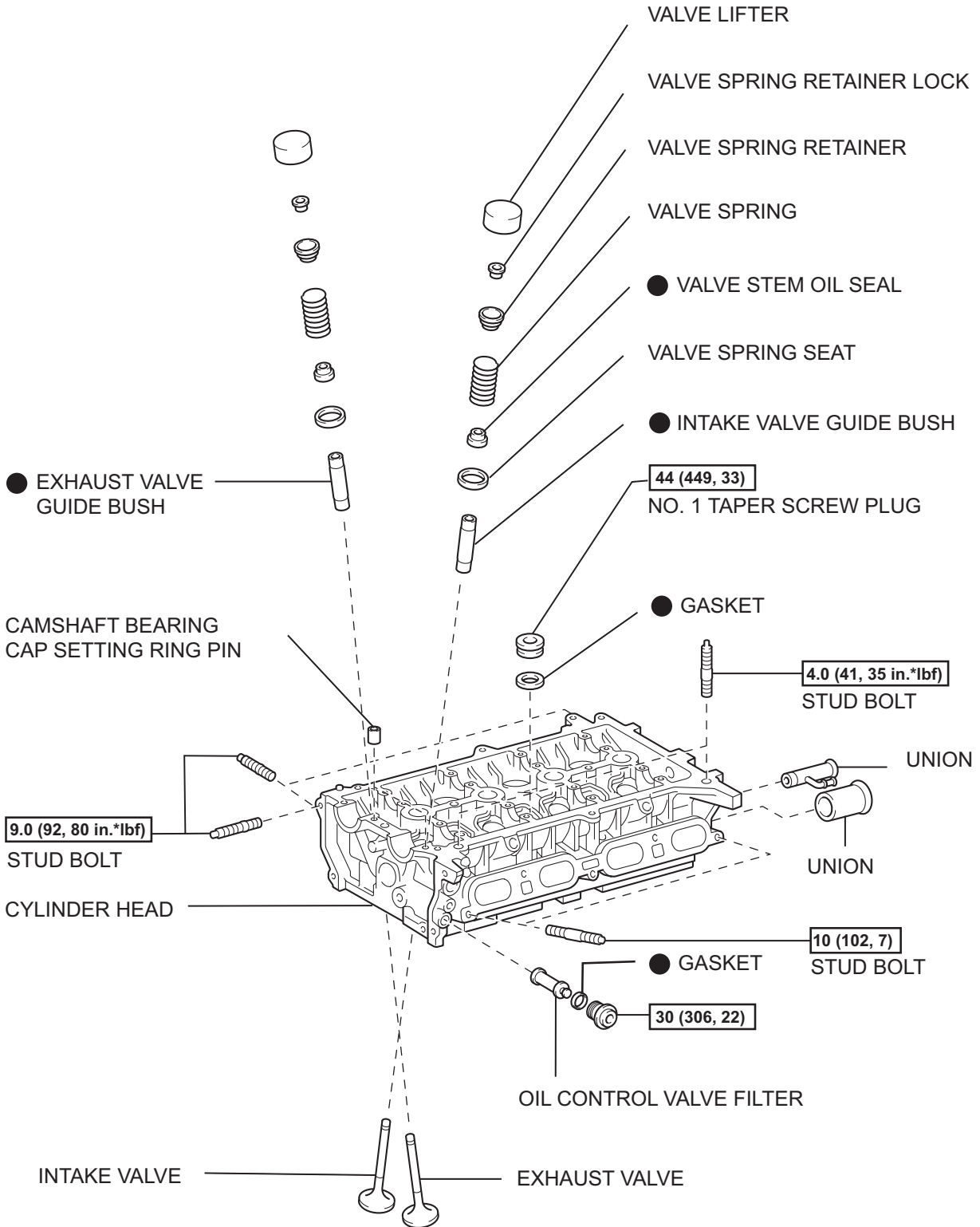

N*m (kgf*cm, ft.*lbf) : Specified torque

● Non-reusable part